

WINDING CONSTANTS *	UNITS	TOL	SYMBOL	WDG A	WDG B
DC RESISTANCE	OHMS	±12.5%	R	18.0	4.1
VOLTAGE @ F <sub>P</sub>	VOLTS	NOMINAL	V <sub>P</sub>	27.0	13.0
CURRENT @ F <sub>P</sub>	AMPERES	NOMINAL	I <sub>P</sub>	1.5	3.18
FORCE SENSITIVITY	LB/AMP	±10%	K <sub>F</sub>	2.33	1.10
	N/AMP	±10%		10.36	4.89
BACK EMF CONSTANT	V/FT/SEC	±10%	K <sub>B</sub>	3.16	1.49
	V/M/SEC	±10%		10.36	4.89
INDUCTANCE ****	MILLI-HENRY	±15%	L	2.44	0.67

ACTUATOR PARAMETERS *	UNITS	SYMBOL	VALUE
PEAK FORCE **	LB	F <sub>P</sub>	3.5
	N		15.6
CONTINUOUS STALL FORCE ***	LB	F <sub>CS</sub>	1.18
	N		5.25
ACTUATOR CONSTANT	LB/√WATT	K <sub>A</sub>	0.55
	N/√WATT		2.45
ELECTRICAL TIME CONSTANT	MILLI-SEC	τ <sub>E</sub>	0.136
MECHANICAL TIME CONSTANT	MILLI-SEC	τ <sub>M</sub>	2.38
POWER I <sup>2</sup> R @ F <sub>P</sub>	WATTS	P <sub>P</sub>	40.5
STROKE	± INCHES		0.125
	± MM		3.18
CLEARANCE ON EACH SIDE OF COIL	IN		0.015
	MM		0.38
THERMAL RESISTANCE OF COIL	°C/WATT	θ <sub>TH</sub>	18.7
MAX. ALLOWABLE COIL TEMP.	°C	TEMP	155
WEIGHT OF COIL ASSEMBLY	oz	WT <sub>C</sub>	0.50
	g		14.2
WEIGHT OF FIELD ASSEMBLY	oz	WT <sub>F</sub>	3.6
	g		102

\* AT MID-STROKE & 25°C AMBIENT TEMPERATURE  
 \*\* 10 SECONDS AT 25°C AMBIENT & 155°C COIL TEMP  
 \*\*\* 25°C AMBIENT & 155°C WINDING TEMPERATURE  
 \*\*\*\* MEASURED AT 1000 Hz

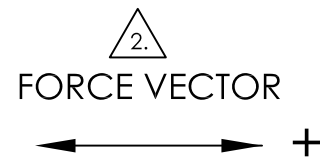
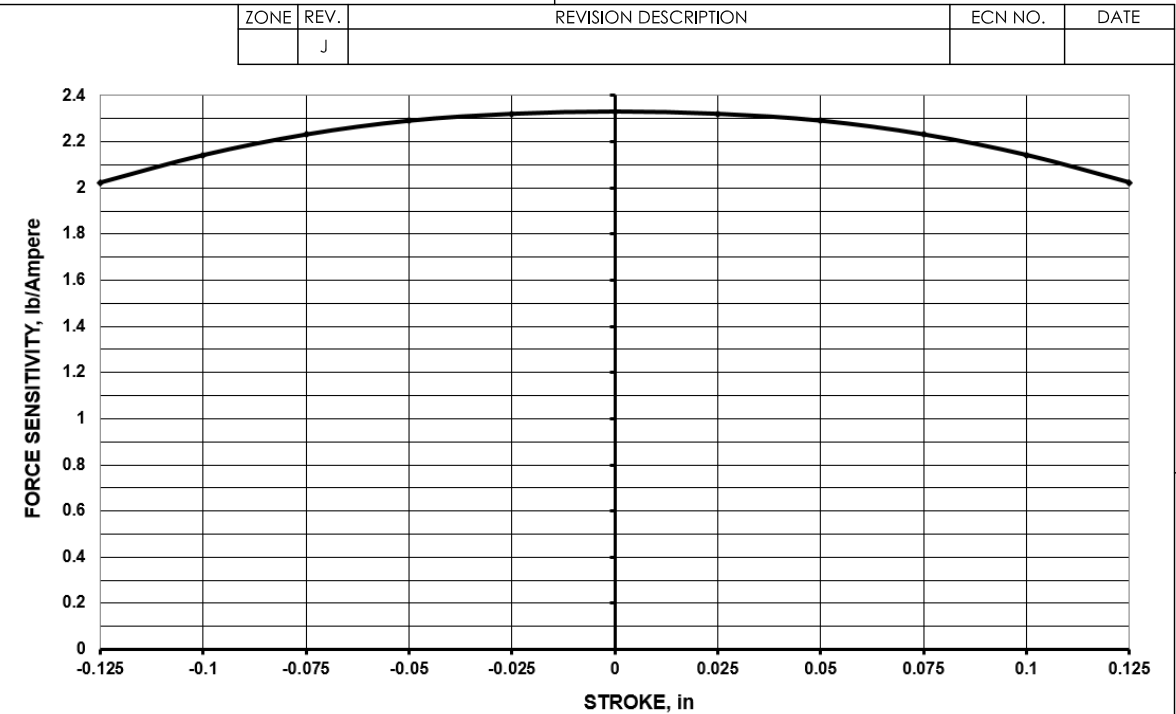
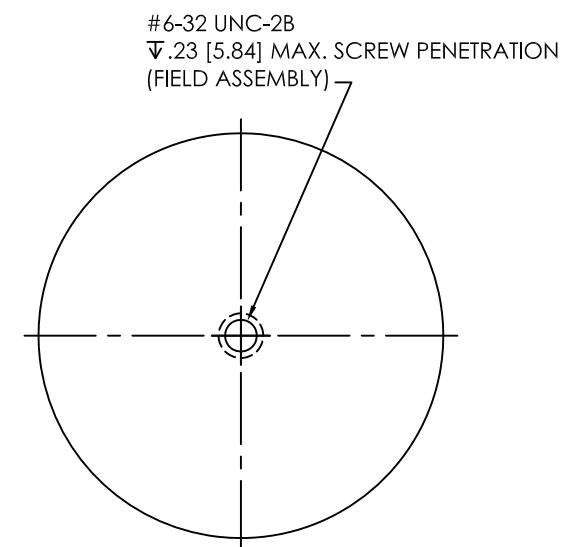
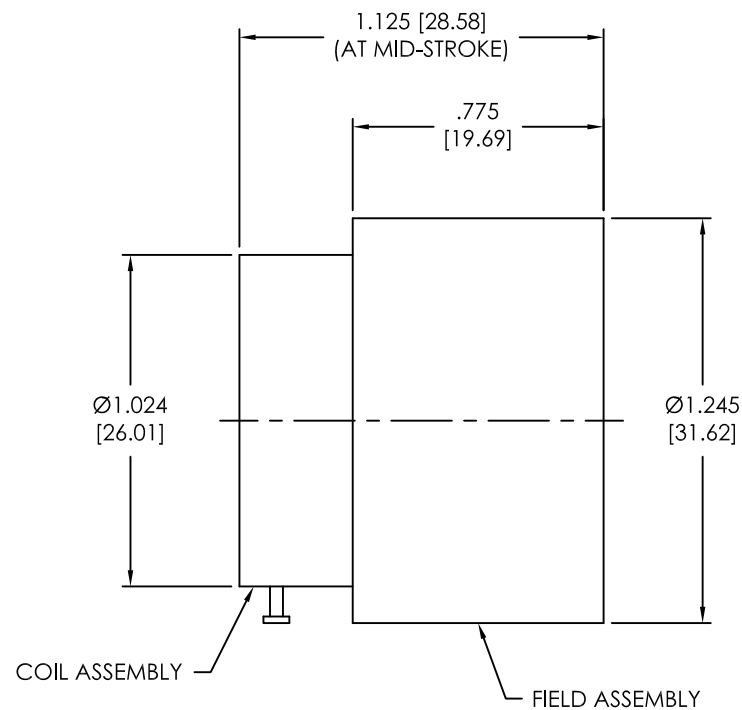
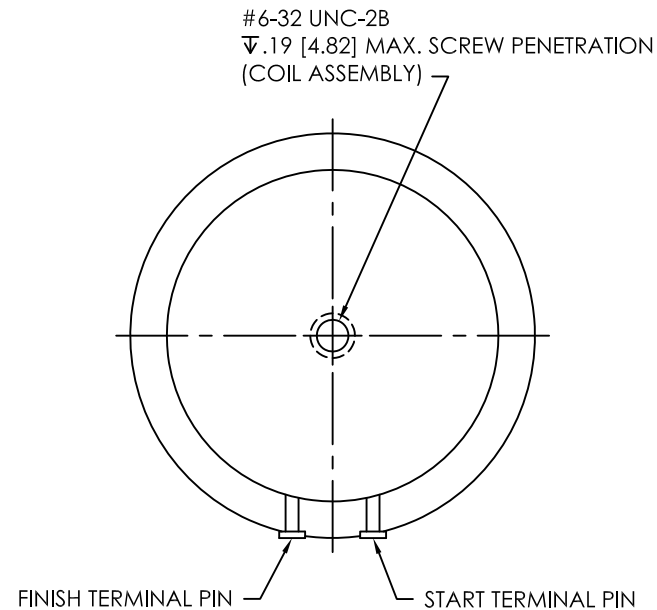

NOTES: UNLESS OTHERWISE SPECIFIED

1. INCH DRAWING, DIMENSIONS IN BRACKETS [ ] ARE IN MILLIMETERS AND ARE FOR REFERENCE ONLY.

2. A POSITIVE (+) VOLTAGE APPLIED TO THE START TERMINAL WILL PRODUCE A FORCE ON THE COIL ASSEMBLY IN THE POSITIVE (+) DIRECTION.

AUTOCAD

FOR REFERENCE ONLY, CHECK LATEST REVISION BEFORE USE.		529 PLEASANT STREET P.O. BOX 2964 ATTLEBORO, MA 02703	
DRAWN	DATE	ENGINEER	TITLE
DATE	APPROVED	DATE	APPROVED
DATE	APPROVED	DATE	APPROVED
DATE	APPROVED	DATE	APPROVED
SENSATA TECHNOLOGIES PROPRIETARY AND CONFIDENTIAL. NEITHER THIS PRINT NOR THE INFORMATION CONTAINED HEREON IS TO BE USED AGAINST THE INTERESTS OF SENSATA TECHNOLOGIES OR AGAINST THE INTERESTS OF ANY OF ITS AFFILIATED COMPANIES OR WHOLLY OWNED SUBSIDIARIES.		INTERPRET DIMENSIONING AND TOLERANCING PER ASME Y14.5-2009. UNLESS OTHERWISE SPECIFIED DIMENSIONS ARE IN INCHES.	
DECIMALS      ANGLES X.X ± 0.03      X.X° ± 0°30' X.XX ± 0.01 X.XXX ± 0.005		SIZE	REV.
DO NOT SCALE DRAWING		C	J
THIRD ANGLE PROJECTION		DWG NO.	SHEET: 1 OF 1
		LA13-12-000-LTR	
		SCALE: NONE	

