

Winding Constants *	Units	Tol	Symbol	Wdg	A
DC Resistance	Ohms	+ 12.5%	R	9.15	
Voltage @ F _{PS}	Volts	Nominal	V _{PS}	45.8	
Current @ F _{PS}	Amps	Nominal	I _{PS}	5	
Current @ F _{CS}	Amps	Nominal	I _{CS}	1.01	
Force Sensitivity @ F _{PS}	N/Amp	+ 10%	K _{FPS}	8.9	
	lb/Amp	+ 10%		2	
Force Sensitivity @ No-Load	N/Amp	+ 10%	K _{FNL}	8.9	
	lb/Amp	+ 10%		2	
Back EMF Constant	V/(m/sec)	+ 10%	K _B	8.9	
	V/(ft/sec)	+ 10%		2.71	
Inductance ****	milli-Henry	+ 15%	L	4.6	

Linear Actuator Parameters *	Units	Symbol	Value
Peak Stall Force**	N	F _{PS}	44.48
	lb		10
Continuos Stall Force ***	N	F _{CS}	8.97
	lb		2.02
Actuator Constant	N/√Watt	K _A	2.94
	lb/√Watt		0.66
Electrical Time Constant	milli-sec	τ _E	0.503
Mechanical Time Constant	milli-sec	τ _M	7.53
Theoretical Acceleration	m/s ²	a _T	682.2
	ft/s ²		2,238.2
Maximum Theoretical Frequency @ Full Stroke and Sinusoidal/Triangular Motion	Hz	f _{max}	34/37.8
Power I ² R @ F _{PS}	Watts	P _{PS}	228.8
Stroke, Maximum	± mm	S _{Amax}	12.7
	± in		0.5
Clearance on Each Side of Coil	mm	D _C	0.38
	in		0.015
Mass, Moving Coil Assembly	g	M _{CA}	65.2
	oz		2.3
Thermal Resistance of Coil in still air	°C/Watt	Θ _{TH}	9.3
Maximum Allowable Coil Winding Temp	°C	T _W	155
Mass, Field Assembly	g	M _{FA}	286.3
	oz		10.1

* AT MID-STROKE POSITION AND @ 25 °C AMBIENT TEMPERATURE.
 ** 10 SECONDS @ 25 °C AMBIENT & 155 °C COIL TEMPERATURE.
 *** @25 °C AMBIENT & 155 °C COIL TEMPERATURE.
 **** MEASURED AT 1000 Hz.

ZONE	REV.	REVISION DESCRIPTION	ECN NO.	DATE
	F			

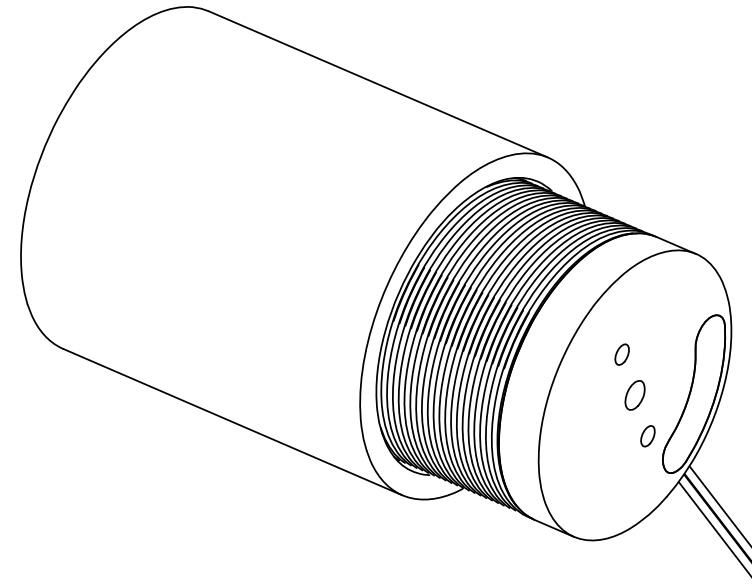
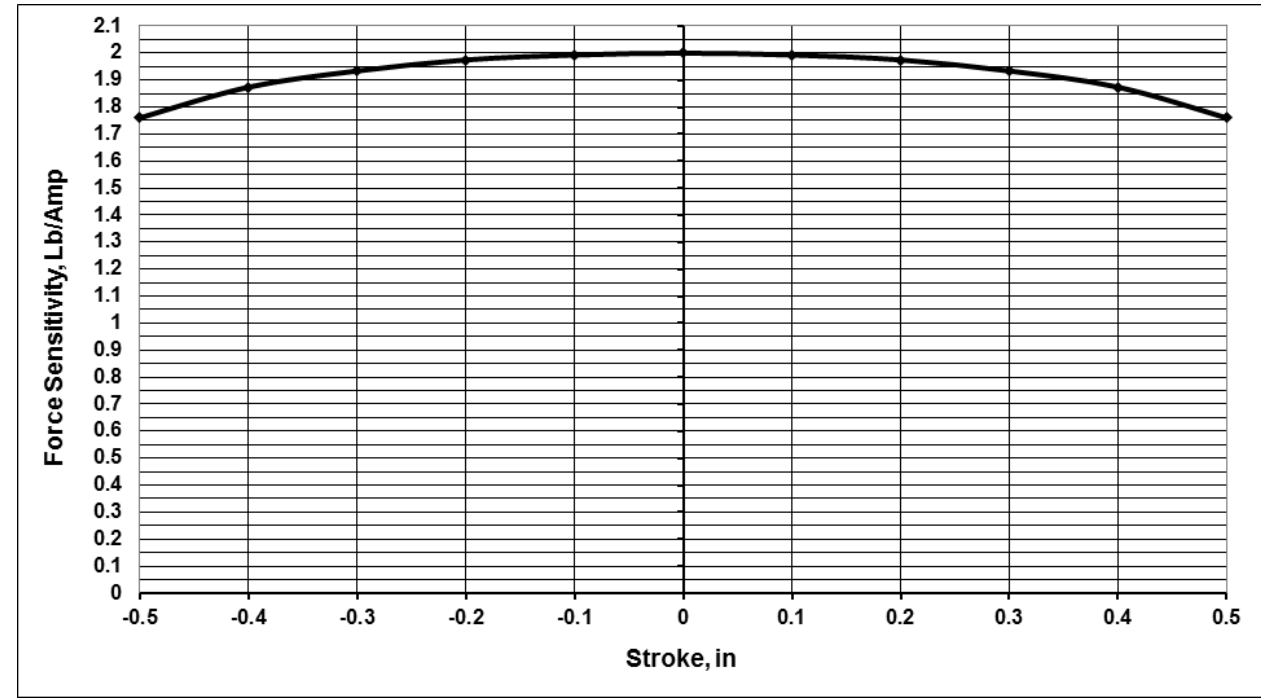

SOLIDWORKS

FOR REFERENCE ONLY, CHECK LATEST REVISION BEFORE USE.		529 PLEASANT STREET P.O. BOX 2964 ATTLEBORO, MA 02703	
DRAWN	SENSATA TECHNOLOGIES PROPRIETARY AND CONFIDENTIAL. NEITHER THIS PRINT NOR THE INFORMATION CONTAINED HEREON IS TO BE USED AGAINST THE INTERESTS OF SENSATA TECHNOLOGIES OR AGAINST THE INTERESTS OF ANY OF ITS AFFILIATED COMPANIES OR WHOLLY OWNED SUBSIDIARIES.	TITLE	
DATE		LINEAR ACTUATOR	
ENGINEER	INTERPRET DIMENSIONING AND TOLERANCING PER ASME Y14.5-2009. UNLESS OTHERWISE SPECIFIED DIMENSIONS ARE IN INCHES. TOLERANCES	SIZE	DWG NO.
DATE		C	LA15-26-000A
APPROVED	DECIMALS ANGLES X.X ± 0.03 X.X° ± 0°30' X.XX ± 0.01 X.XXX ± 0.005	REV.	F
DATE	DO NOT SCALE DRAWING	THIRD ANGLE PROJECTION	SCALE 2:1
APPROVED			SHEET 1 OF 2
DATE			



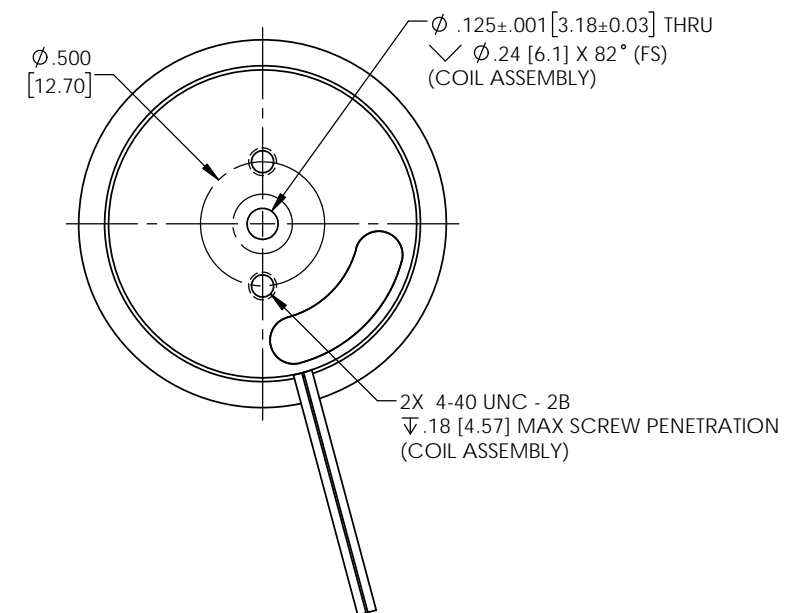
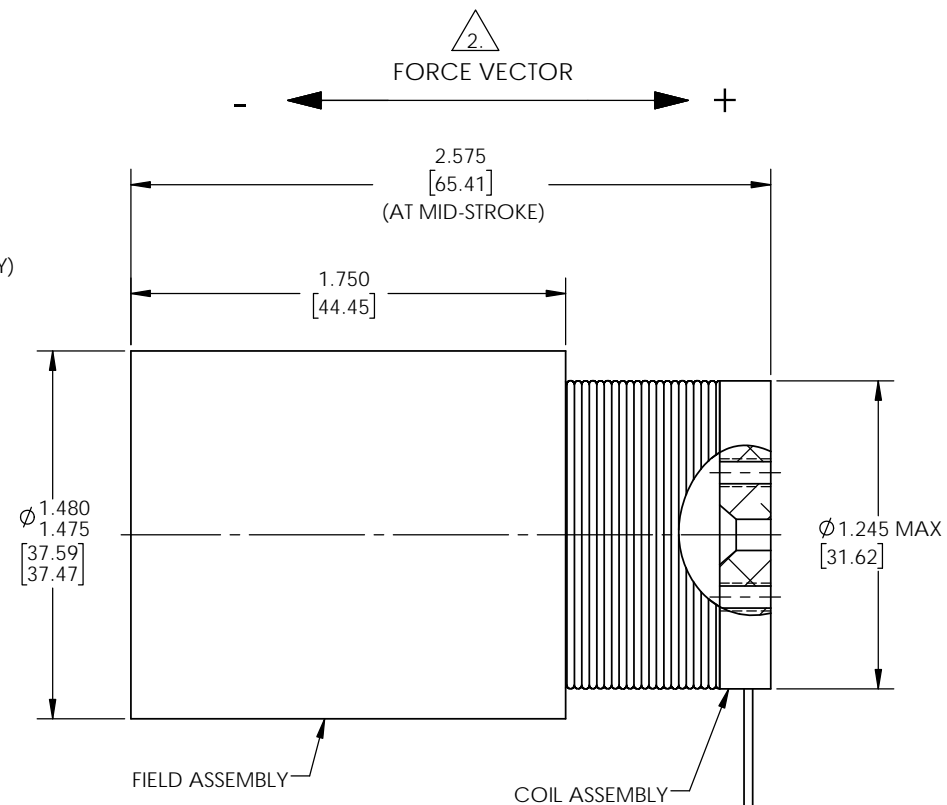
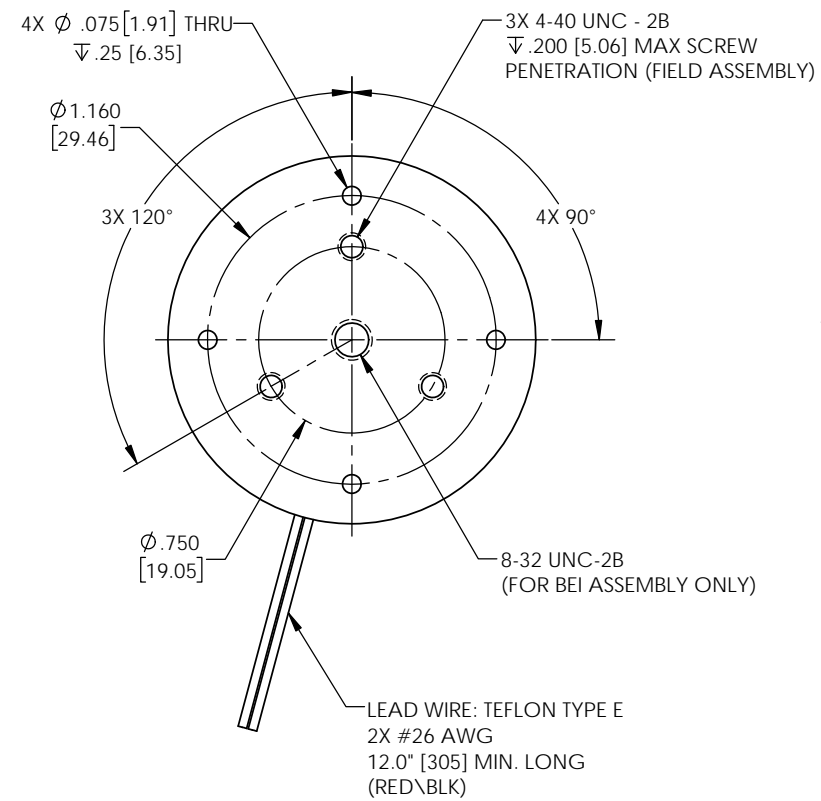

NOTES: UNLESS OTHERWISE SPECIFIED

1. INCH DRAWING. DIMENSIONS IN BRACKETS [] ARE IN MILLIMETERS AND ARE FOR REFERENCE ONLY.

2. A POSITIVE (+) VOLTAGE APPLIED TO THE RED LEAD WIRE WILL PRODUCE A FORCE ON THE COIL ASSEMBLY IN THE POSITIVE (+) DIRECTION.

		529 PLEASANT STREET P.O. BOX 2964 ATTLEBORO, MA 02703
SIZE	DWG NO.	REV.
C	LA15-26-000A	F
SCALE	SOLIDWORKS	SHEET 2 OF 2
2:1		

