

4

3

2

1

ZONE	REV.	REVISION DESCRIPTION	ECN NO.	DATE

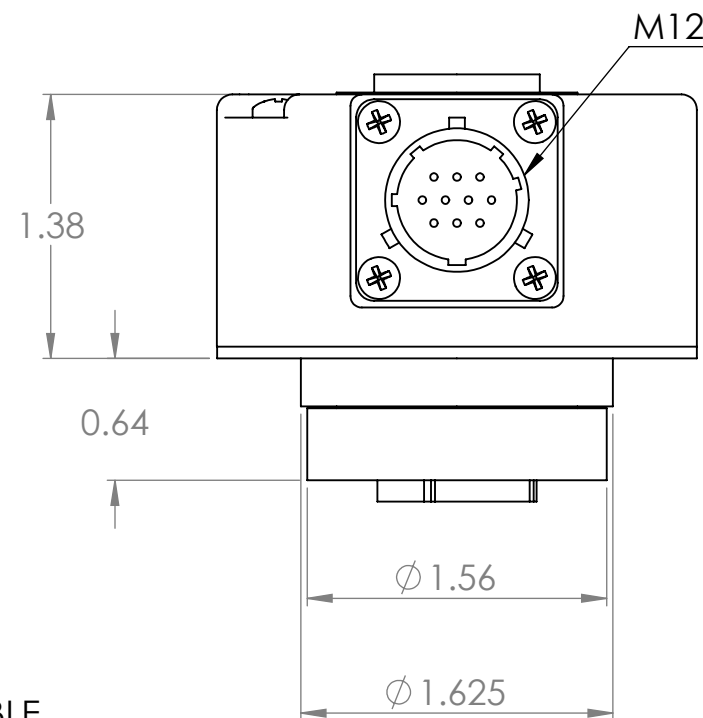
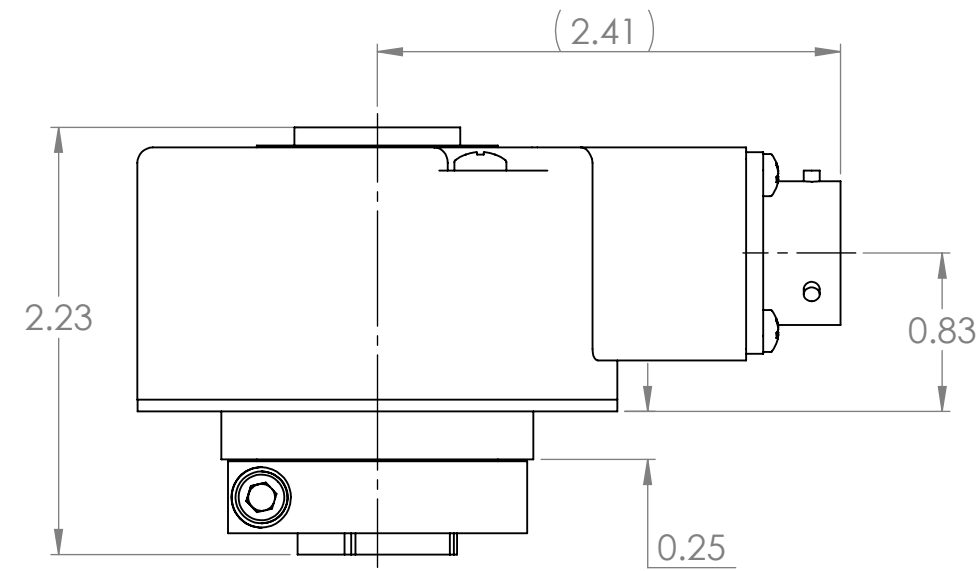
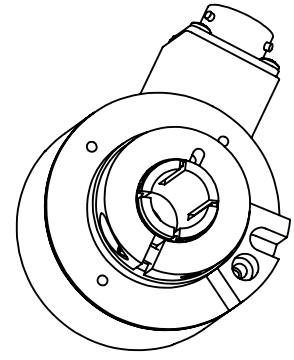
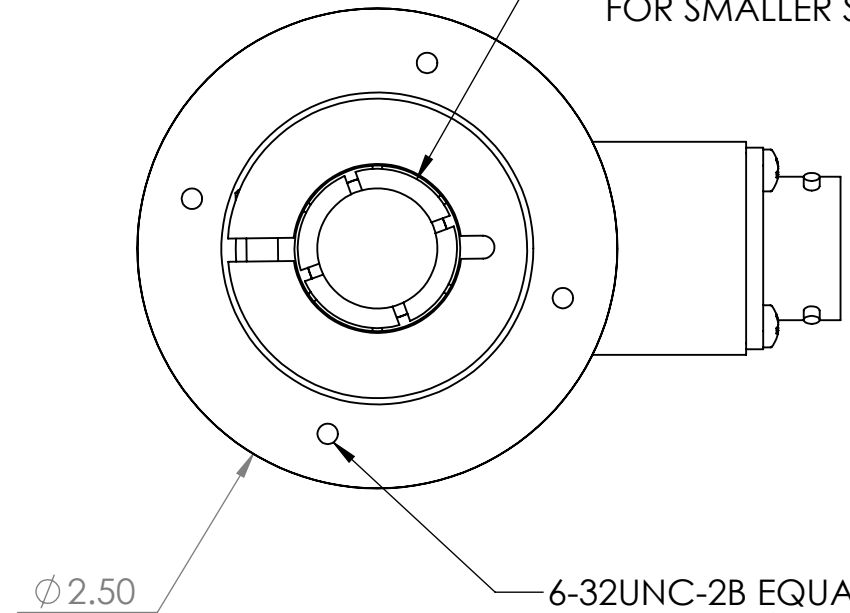

TABLE 1
STANDARD CHANNEL PIN-OUT

FUNCTION	CONN. PIN
A	A
B	B
Z	C
+V	D
-	E
0V	F
CASE GROUND	G
A/	H
B/	J
Z/	K

.750 STANDARD SHAFT I.D.,
REDUCER BUSHINGS AVAILABLE
FOR SMALLER SHAFTS



SHOWN WITH TETHER BLOCK
(R1) OPTION

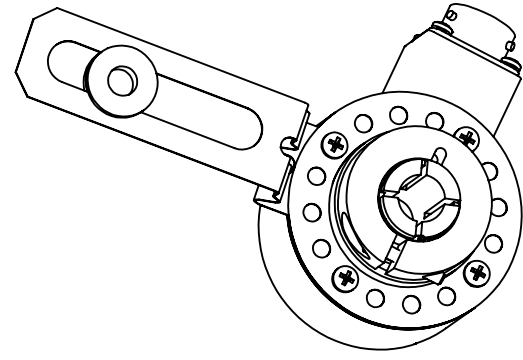

SHOWN WITH TETHER ARM
(R2) OPTION

SAMPLE MODEL NUMBER: HS25-62-R2-SS-1024-ABZC-28/V-SM12
 SAMPLE PART NUMBER: 01072-XXXX
 REFERENCE SPEC 02352-001

UNCONTROLLED COPY		 BEI SENSORS 1461 LAWRENCE DRIVE THOUSAND OAKS, CA 93120
FIRST ISSUE DATE: 11/25/20 DRAWN: DRC APPROVED: DATE: XX/XX/XX	SENSATA TECHNOLOGIES PROPRIETARY AND CONFIDENTIAL. NEITHER THIS PRINT NOR THE INFORMATION CONTAINED HEREON IS TO BE USED AGAINST THE INTERESTS OF SENSATA TECHNOLOGIES OR AGAINST THE INTERESTS OF ANY OF ITS AFFILIATED COMPANIES OR WHOLLY OWNED SUBSIDIARIES.	
ECN: DATE: MATERIAL:	INTERPRET DIMENSIONING AND TOLERANCING PER ASME Y14.5-2009. UNLESS OTHERWISE SPECIFIED DIMENSIONS ARE IN INCHES [MILLIMETERS] AND ARE INTENDED AS NOMINAL SEE PRODUCT SPECIFICATIONS FOR MORE DETAILS.	TITLE ENCODER, HS25 THRU SHAFT WITH SIDE MOUNTED M12 CONNECTOR
DO NOT SCALE DRAWING	THIRD ANGLE PROJECTION	SIZE DWG NO. REV. B 09927-HS25-SM12 A
SCALE 1:1 SOLIDWORKS SHEET 1 OF 1		PROJECT: 1

4

3

2

1

DEVICE: PROJECT: