

DRA3P & DRA3R SERIES

3 PHASE AC CONTACTORS & AC MOTOR REVERSING CONTACTORS

DRA3 Series Solid State Contactors offer the advantages of Crydom's proven state-of-the-art solid state AC switching technology in a ready-to-use contactor which requires no additional heat sinking. DRA3 Series Contactors include a protective Forward/Reverse interlock for motor reversing and are ideal for applications up to 2 Horse Power. For complete specifications, see DRA3P Series AC 3 Phase Contactors & DRA3R AC Motor Reversing Contactors datasheets at www.sensata.com.

Features

- 45 mm wide 3 phase & 62 mm wide motor reversing DIN rail mountable versions available
- 480 VAC Operating Voltage
- 5 VDC, 24 VDC, 48 VAC, 120 VAC & 230 VAC Input Control Voltage options available
- Protective Forward/Reverse interlock built-in function for motor reversing
- UL and IEC general use & Motor ratings available
- LED Status indicator for Input Control Voltage

INSTALLATION INSTRUCTIONS

Please read all installation instructions before using DRA3 Series 3 Phase / Reversing Contactors.

- Install the contactor on the DIN rail as shown in fig. 1. Vertical mounting operation is recommended.
- Wire the contactor to the input control side following the corresponding wiring diagram (fig. 3 or fig. 4). AWG #24 minimum, AWG #12 maximum (0.2-3.3 mm²), choose wire gauge according to load current. Maximum recommended terminal screw torque input 4.3 lb-in (0.5 Nm).
- Wire the contactor to the AC Line side (L1, L2 & L3) and to the Load side (T1, T2 & T3). AWG #24 minimum, AWG #10 maximum (0.3-5.3 mm²), choose wire gauge according to load current. Maximum recommended terminal screw torque output 12 lb-in (1.37 Nm).
- If multiple units are installed be sure to follow derating curve (fig. 2)

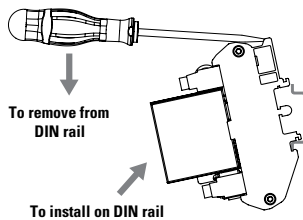

fig. 1 Mounting/Dismounting contactor on DIN rail

DERATING CURVES (A, B)

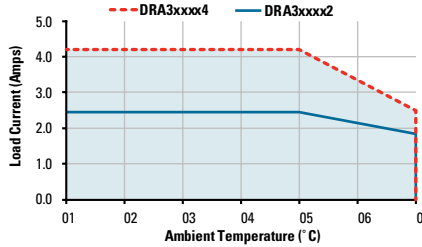

fig. 2 Derating Curve for 3 Phase & Motor Reversing contactor.

Temp.	DRA3Pxxx2	DRA3Pxxx4	DRA3Rxxx2	DRA3Rxxx4
40°C	1 HP (0.75 KW) ^(A)	2 HP (0.75 KW)	1 HP (0.75 KW)	2 HP (1.5 KW)
60°C	¾ HP (0.55 KW) ^(A)	1 HP (0.37 KW)	¾ HP (0.55 KW)	1 HP (0.75 KW)

ORDERING OPTIONS

	DRA	3P	48	D	4	R	2
Series	Series						
DRA	DRA						
Function	Function						
3P: Contactor	3P: Contactor						
3R: Reversible	3R: Reversible						
Operating Voltage	Operating Voltage						
40: 48-415 VAC (Only for 3R)	40: 48-415 VAC (Only for 3R)						
48: 48-510 VAC	48: 48-510 VAC						
Control Voltage	Control Voltage						
D: 4-6 VDC	D: 4-6 VDC						
E: 18-28 VDC	E: 18-28 VDC						
A: 200-265 VAC	A: 200-265 VAC						
B: 90-140 VAC	B: 90-140 VAC						
C: 36-60 VAC	C: 36-60 VAC						
Rated Load Current	Rated Load Current						
2: 2.4 Amp/ 1HP @ 480 VAC	2: 2.4 Amp/ 1HP @ 480 VAC						
4: 4.2 Amp/ 2HP @ 480 VAC	4: 4.2 Amp/ 2HP @ 480 VAC						
Switching Type (Only for 3P)	Switching Type (Only for 3P)						
Blank: Zero Voltage Turn-On	Blank: Zero Voltage Turn-On						
R: Instantaneous Turn-On	R: Instantaneous Turn-On						
Controlled Legs (Only for 3P)	Controlled Legs (Only for 3P)						

Blank: Zero Voltage Turn-On
R: Instantaneous Turn-On

Blank: 3 Legs
2: 2 Legs



Required for valid part number

For options only and not required for valid part number

DRA3P & DRA3R (E, R)

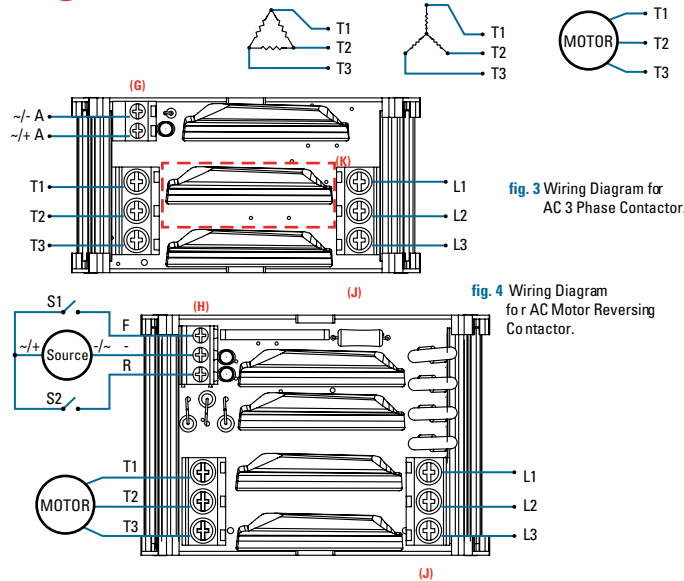
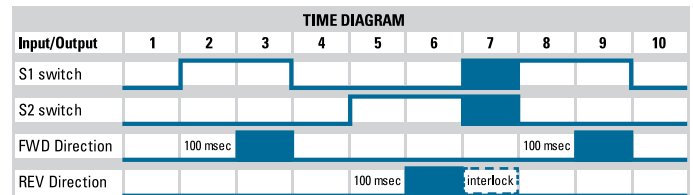

fig. 3 Wiring Diagram for AC 3 Phase Contactor.

fig. 4 Wiring Diagram for AC Motor Reversing Contactor.

S1	S2	Forward	Reverse
Open	Open	Off	Off
Closed	Open	On	Off
Open	Closed	Off	On
Closed	Closed	Off	Off





GENERAL NOTES

- ^(A) Unless otherwise noted, all ratings are at 0 mm air gap for adjacent similar parts.
- ^(B) Resistive Load Current rating for AC Control is 3.4 A @ 0 mm air gap. For maximum ratings use 45 mm air gap.
- ^(C) AC-53a rating for DRA3Pxxx2 (A, B & C suffix) is 0.55 KW @ 480 VAC.
- ^(D) AC-53a rating for DRA3Pxxx2 (A, B & C suffix) is 0.37 KW @ 480 VAC.
- ^(E) No grounding wire required.
- ^(F) Minimum wire strip length 0.197 in (5 mm), maximum 0.235 in (6 mm) for input terminals. Minimum wire strip length 0.315 in (8 mm), maximum 0.354 in (9 mm) for output terminals.
- ^(G) 2 Input control terminal screws M2.5 Combo Drive.
- ^(H) 3 Input control terminal screws M2.5 Slotted Drive.
- ^(I) 6 Output terminal screws (L1, L2 & L3 / T1, T2 & T3) M3.5 Combo Drive.
- ^(K) 3 Controlled legs versions only

Sensata Technologies, Inc. ("Sensata") data sheets are solely intended to assist designers ("Buyers") who are developing systems that incorporate Sensata products (also referred to herein as "components"). Buyer understands and agrees that Buyer remains responsible for using its independent analysis, evaluation and judgment in designing Buyer's systems and products. Sensata data sheets have been created using standard laboratory conditions and engineering practices. Sensata has not conducted any testing other than that specifically described in the published documentation for a particular data sheet. Sensata may make corrections, enhancements, improvements and other changes to its data sheets or components without notice.

Buyers are authorized to use Sensata data sheets with the Sensata component(s) identified in each particular data sheet. HOWEVER, NO OTHER LICENSE, EXPRESS OR IMPLIED, BY ESTOPPEL OR OTHERWISE TO ANY OTHER SENSATA INTELLECTUAL PROPERTY RIGHT, AND NO LICENSE TO ANY THIRD PARTY TECHNOLOGY OR INTELLECTUAL PROPERTY RIGHT, IS GRANTED HEREIN. SENSATA DATA SHEETS ARE PROVIDED "AS IS". SENSATA MAKES NO WARRANTIES OR REPRESENTATIONS WITH REGARD TO THE DATA SHEETS OR USE OF THE DATA SHEETS, EXPRESS, IMPLIED OR STATUTORY, INCLUDING ACCURACY OR COMPLETENESS. SENSATA DISCLAIMS ANY WARRANTY OF TITLE AND ANY IMPLIED WARRANTIES OF MERCHANTABILITY, FITNESS FOR A PARTICULAR PURPOSE, QUIET ENJOYMENT, QUIET POSSESSION, AND NON-INFRINGEMENT OF ANY THIRD PARTY INTELLECTUAL PROPERTY RIGHTS WITH REGARD TO SENSATA DATA SHEETS OR USE THEREOF.

All products are sold subject to Sensata's terms and conditions of sale supplied at www.sensata.com SENSATA ASSUMES NO LIABILITY FOR APPLICATIONS ASSISTANCE OR THE DESIGN OF BUYERS' PRODUCTS. BUYER ACKNOWLEDGES AND AGREES THAT IT IS SOLELY RESPONSIBLE FOR COMPLIANCE WITH ALL LEGAL, REGULATORY AND SAFETY-RELATED REQUIREMENTS CONCERNING ITS PRODUCTS, AND ANY USE OF SENSATA COMPONENTS IN ITS APPLICATIONS, NOTWITHSTANDING ANY APPLICATIONS-RELATED INFORMATION OR SUPPORT THAT MAY BE PROVIDED BY SENSATA.
Mailing Address: Sensata Technologies, Inc., 529 Pleasant Street, Attleboro, MA 02703, USA.

CONTACT US

Americas

+1 (877) 502 5500
sales.crydom@sensata.com

Europe, Middle East & Africa

+44 (1202) 416170
ssr-info.eu@sensata.com

Asia Pacific

sales.isasia@list.sensata.com
China +86 (21) 2306 1500
Japan +81 (45) 277 7117
Korea +82 (31) 601 2004
India +91 (80) 67920890
Rest of Asia +886 (2) 27602006
ext 2808