

WINDING CONSTANTS *	UNITS	TOL	SYMBOL	WDG A
DC RESISTANCE	OHMS	±12.5%	R	2.2
VOLTAGE @ F _P	VOLTS	NOMINAL	V _P	22.0
CURRENT @ F _P	AMPERES	NOMINAL	I _P	10.0
FORCE SENSITIVITY	LB/AMP	±10%	K _F	2.5
	N/AMP	±10%		11.12
BACK EMF CONSTANT	V/FT/SEC	±10%	K _B	3.4
	V/M/SEC	±10%		11.15
INDUCTANCE ****	MILLI-HENRY	±15%	L	2.05

ACTUATOR PARAMETERS *	UNITS	SYMBOL	VALUE
PEAK FORCE **	LB	F _P	25
	N		111.21
CONTINUOUS STALL FORCE ***	LB	F _{CS}	5.9
	N		26.3
ACTUATOR CONSTANT	LB/√WATT	K _A	1.69
	N/√WATT		7.52
ELECTRICAL TIME CONSTANT	MICRO-SEC	τ _E	932
MECHANICAL TIME CONSTANT	MILLI-SEC	τ _M	2.9
POWER I ² R @ F _P	WATTS	P _P	220
STROKE	± INCHES		0.325
	± MM		8.26
CLEARANCE ON EACH SIDE OF COIL	IN		0.015
	MM		0.38
THERMAL RESISTANCE OF COIL	°C/WATT	Θ _{TH}	7.1
MAX. ALLOWABLE COIL TEMP.	°C	TEMP	155
WEIGHT OF COIL ASSEMBLY	LB	WT _C	0.365
	kg		0.17
WEIGHT OF FIELD ASSEMBLY	LB	WT _F	1.25
	kg		0.57

* AT MID-STROKE & 25°C AMBIENT TEMPERATURE
 ** 10 SECONDS AT 25°C AMBIENT & 155°C COIL TEMP
 *** 25°C AMBIENT & 155°C WINDING TEMPERATURE
 **** MEASURED AT 1000 Hz

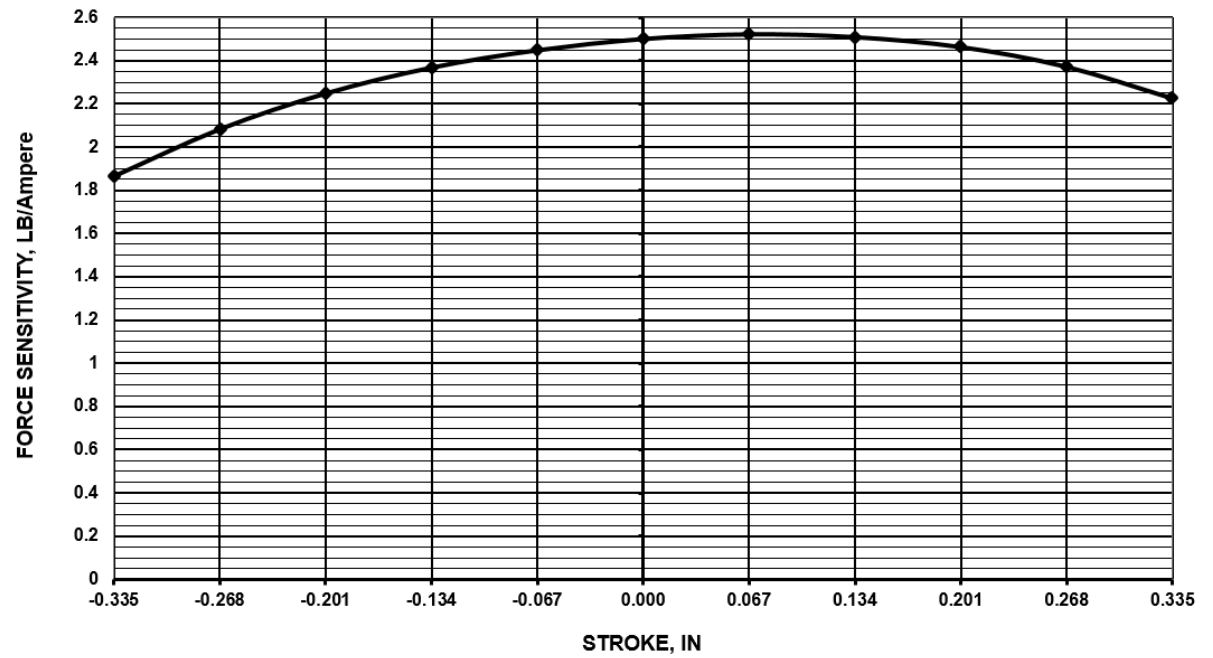
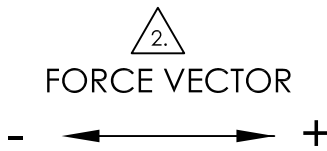
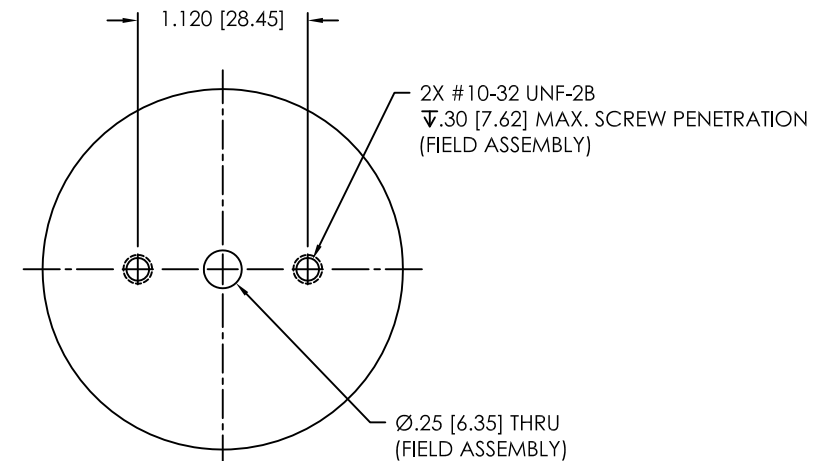
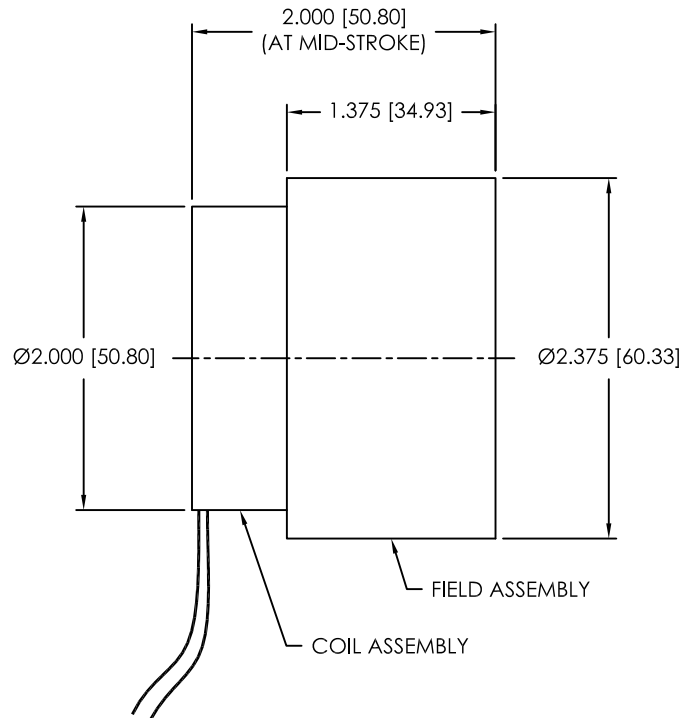
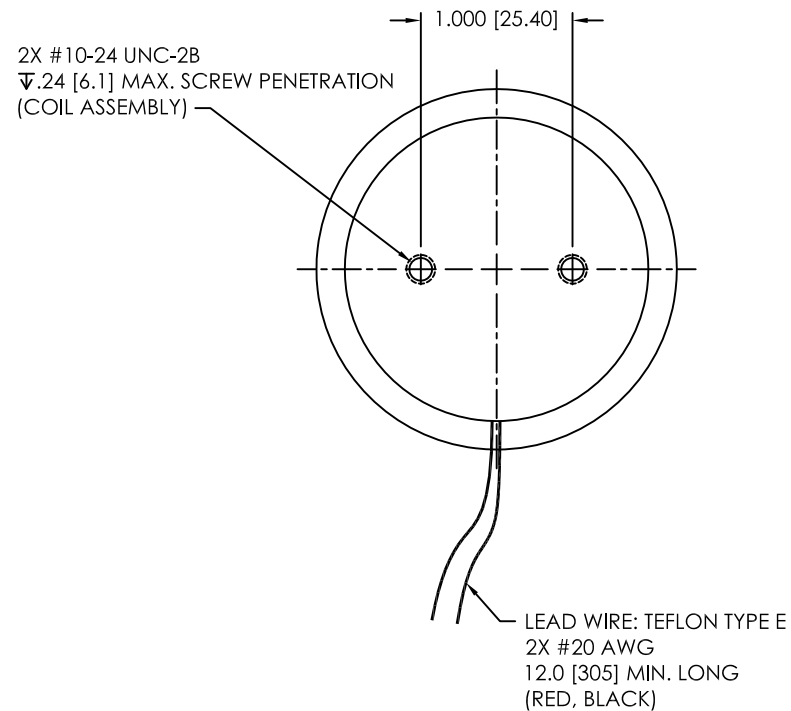

NOTES: UNLESS OTHERWISE SPECIFIED

1. INCH DRAWING, DIMENSIONS IN BRACKETS [] ARE IN MILLIMETERS AND ARE FOR REFERENCE ONLY.

2. A POSITIVE (+) VOLTAGE APPLIED TO THE RED LEAD WIRE WILL PRODUCE A FORCE ON THE COIL ASSEMBLY IN THE POSITIVE (+) DIRECTION.

FOR REFERENCE ONLY, CHECK LATEST REVISION BEFORE USE.

DRAWN	SENSATA TECHNOLOGIES PROPRIETARY AND CONFIDENTIAL. THIS PRINT NOR THE INFORMATION CONTAINED HEREON IS TO BE USED AGAINST THE INTERESTS OF SENSATA TECHNOLOGIES OR AGAINST THE INTERESTS OF ANY OF ITS AFFILIATED COMPANIES OR WHOLLY OWNED SUBSIDIARIES. INTERPRET DIMENSIONING AND TOLERANCING PER ASME Y14.5-2009. UNLESS OTHERWISE SPECIFIED DIMENSIONS ARE IN INCHES. TOLERANCES DECIMALS ANGLES X.X ± 0.03 X.X° ± 0°30' X.XX ± 0.01 X.XXX ± 0.005	DATE	DO NOT SCALE DRAWING	THIRD ANGLE PROJECTION
ENGINEER		DATE		
APPROVED		DATE		
DATE		APPROVED		
DATE		DATE		

529 PLEASANT STREET
 P.O. BOX 2964
 ATTLEBORO, MA 02703

		TITLE
LINEAR ACTUATOR		REV.
SIZE	DWG NO.	F
C	LA24-20-000A	
SCALE: NONE	SHEET: 1 OF 1	

