

PART NO: (LBK010)
 2 AXIS LATHE KIT
 FITS 2 SPHEORSYN "300" OR "SERIAL" ENCODERS
 USE IN CONJUCTION WITH ENCODER INSTALL GUIDE 023-8251

CROSS AXIS OPTION A

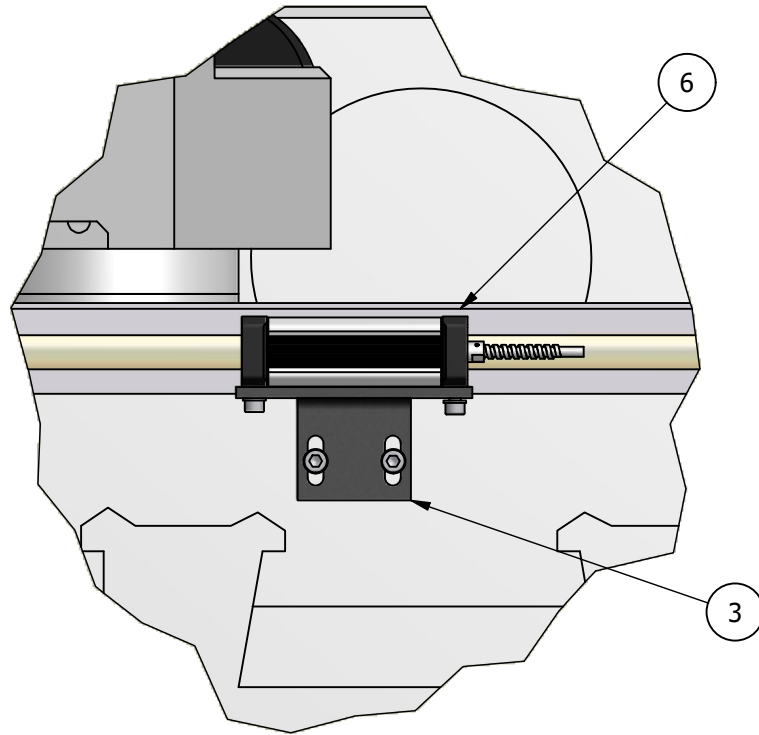

CROSS AXIS OPTION B

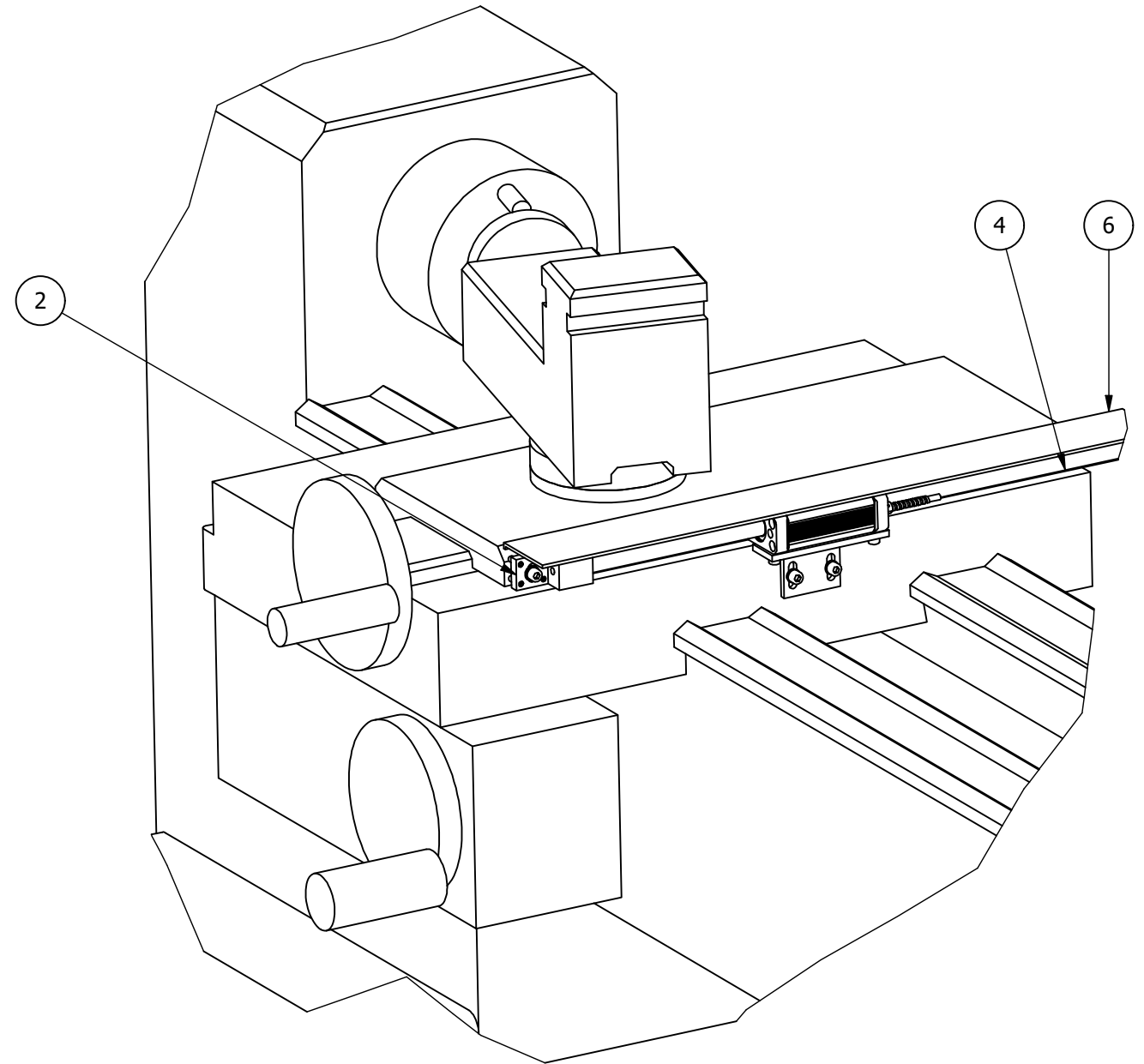
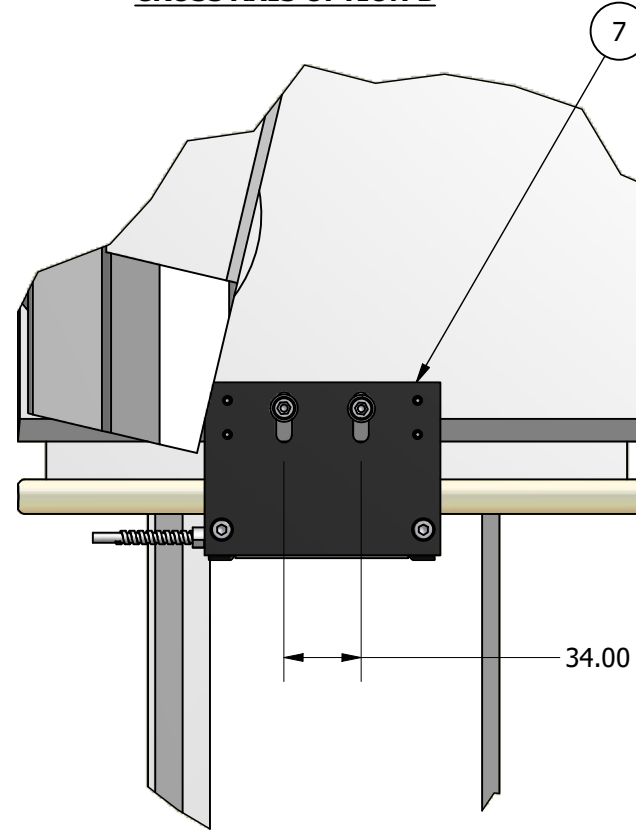

SECURE CABLE AS DETAILED IN 023-82510

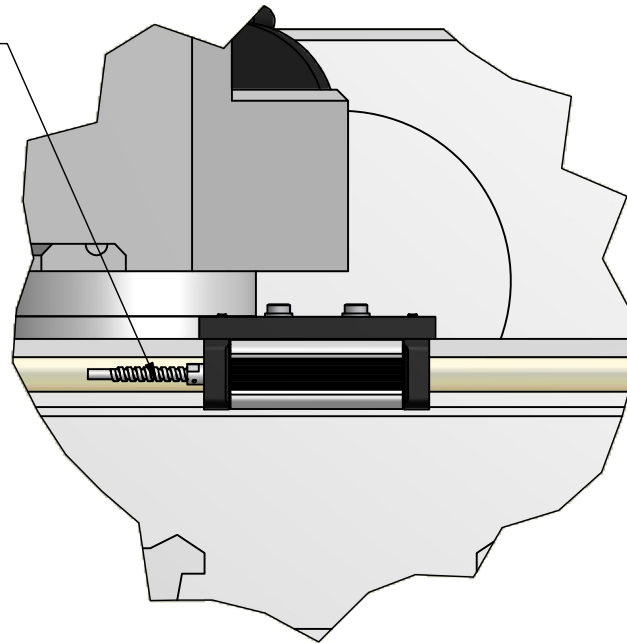
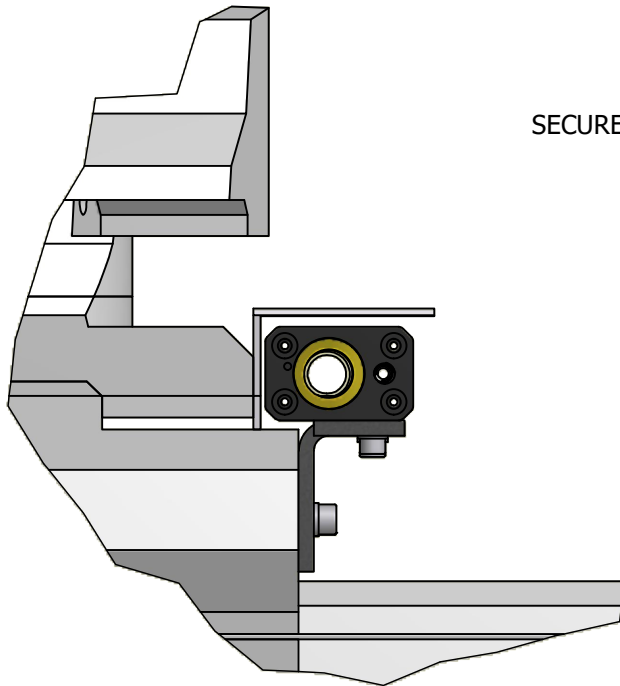

Parts List			
ITEM	QTY	PART NUMBER	DESCRIPTION
1	1	"S300***/"SE**"	S300 OR SERIAL ENCODER (AS ORDERED)
2	1	SSS010, SHD010	SCALE MOUNTING KIT (AS ORDERED)
3	1	295-00975	S300 CROSS AXIS BRACKET A
4	1	"SS***/" OR "SLT**"	SCALE (AS ORDERED)
6	1	***	GAURD INCLUDED WITH SCALE (SOME MODIFICATION MAY BE REQUIRED)
7	1	295-00990	S300 ENCODER PLATE BRACKET

REV. ISS.	DATE	C.N.No	ALTERATION	TITLE LBK010 - BRACKET KIT	MATERIAL/FINISH SEE ABOVE	SCALE N.T.S	UNLESS OTHERWISE STATED: - DIMENSIONS ARE IN M.M	TOLERANCES: - 0 DECIMAL PLACES ± 0.5 1 DECIMAL PLACES ± 0.2 2 DECIMAL PLACES ± 0.1 ANGULAR ± 1'
				DRAWN Chris.Wh DATE 21/12/2017	Leicester	SHEET 1 OF 3	DRAWING NUMBER 023-82392	REV. ISS. 0

NEWALL England

THIS DRAWING IS THE PROPERTY OF NEWALL MEASUREMENT SYSTEMS LTD. THE INFORMATION THEREON MAY NOT BE COPIED OR USED WITHOUT WRITTEN PERMISSION

BED AXIS FITTING

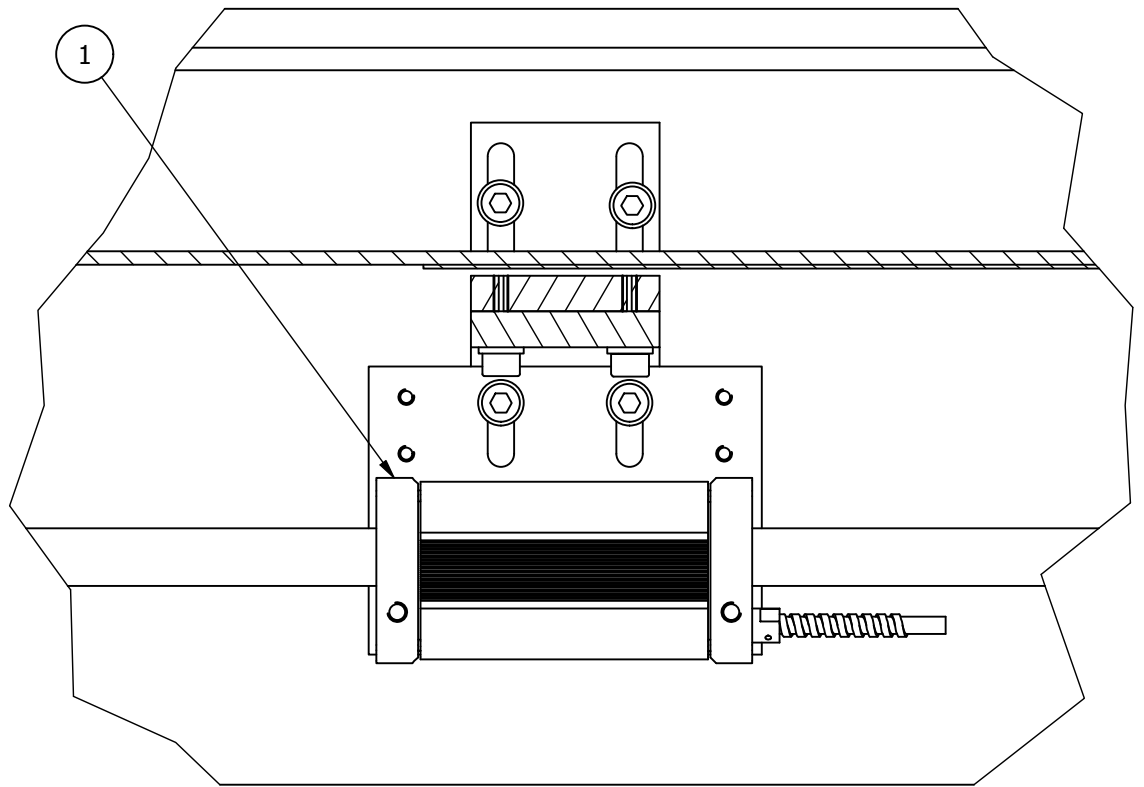
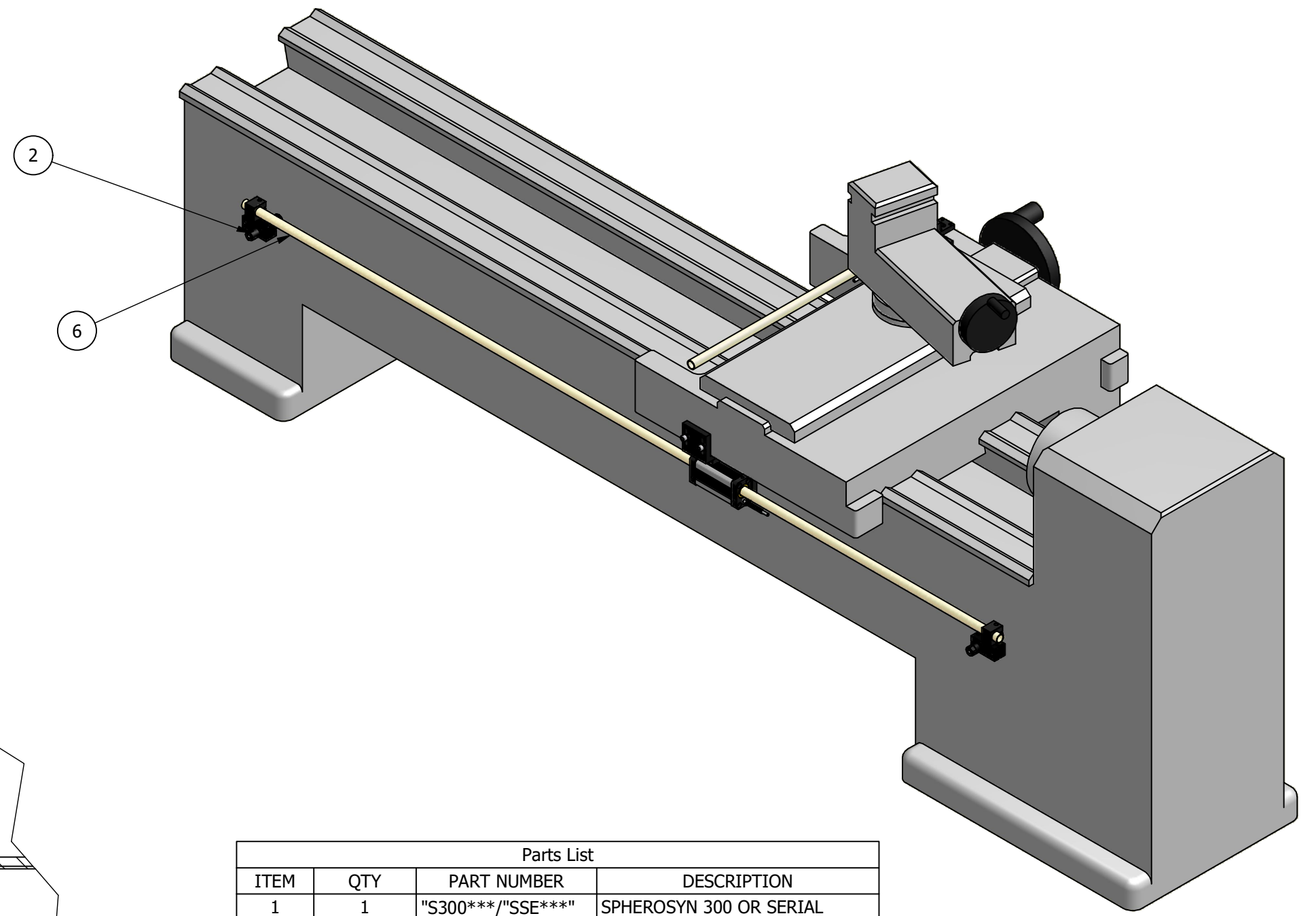
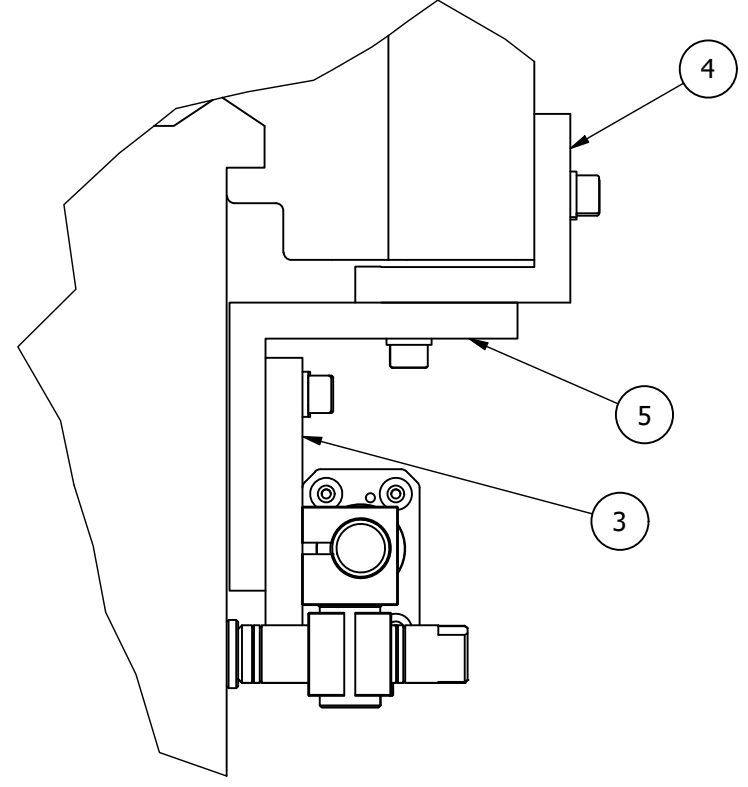

Parts List			
ITEM	QTY	PART NUMBER	DESCRIPTION
1	1	"S300***/"SSE****"	SPHEROSYN 300 OR SERIAL ENCODER AS ORDERED
2	1	SSS010/SSD010	SCALE BRACKETS (AS ORDERED)
3	1	295-00990	S300 PLATE BRACKET A
4	1	ED-2768-01	TAPPED ANGLE
5	1	ED-2768-10	HEAVY DUTY TAPPED ANGLE
6	1	"SS****" OR "SLT****"	SCALE AS ORDERED

				TITLE LBK010 - BRACKET KIT		MATERIAL/FINISH SEE ABOVE		SCALE N.T.S.		UNLESS OTHERWISE STATED: - TOLERANCES: - 0 DECIMAL PLACES ± 0.5 1 DECIMAL PLACES ± 0.2 2 DECIMAL PLACES ± 0.1 ANGULAR ± 1'	
				DRAWN Chris.Wh		Leicester NEWALL England		SHEET 2 OF 3		DIMENSIONS ARE IN M.M.	
REV. ISS.	DATE	C.N.No	ALTERATION	DATE	21/12/2017			DRAWING NUMBER		023-82392	
										REV. ISS. 0	

THIS DRAWING IS THE PROPERTY OF NEWALL MEASUREMENT SYSTEMS LTD. THE INFORMATION THEREON MAY NOT BE COPIED OR USED WITHOUT WRITTEN PERMISSION

KIT CONTENTS FOR: LBK010

(QTY 2) 295-00990 PLATE BRACKET

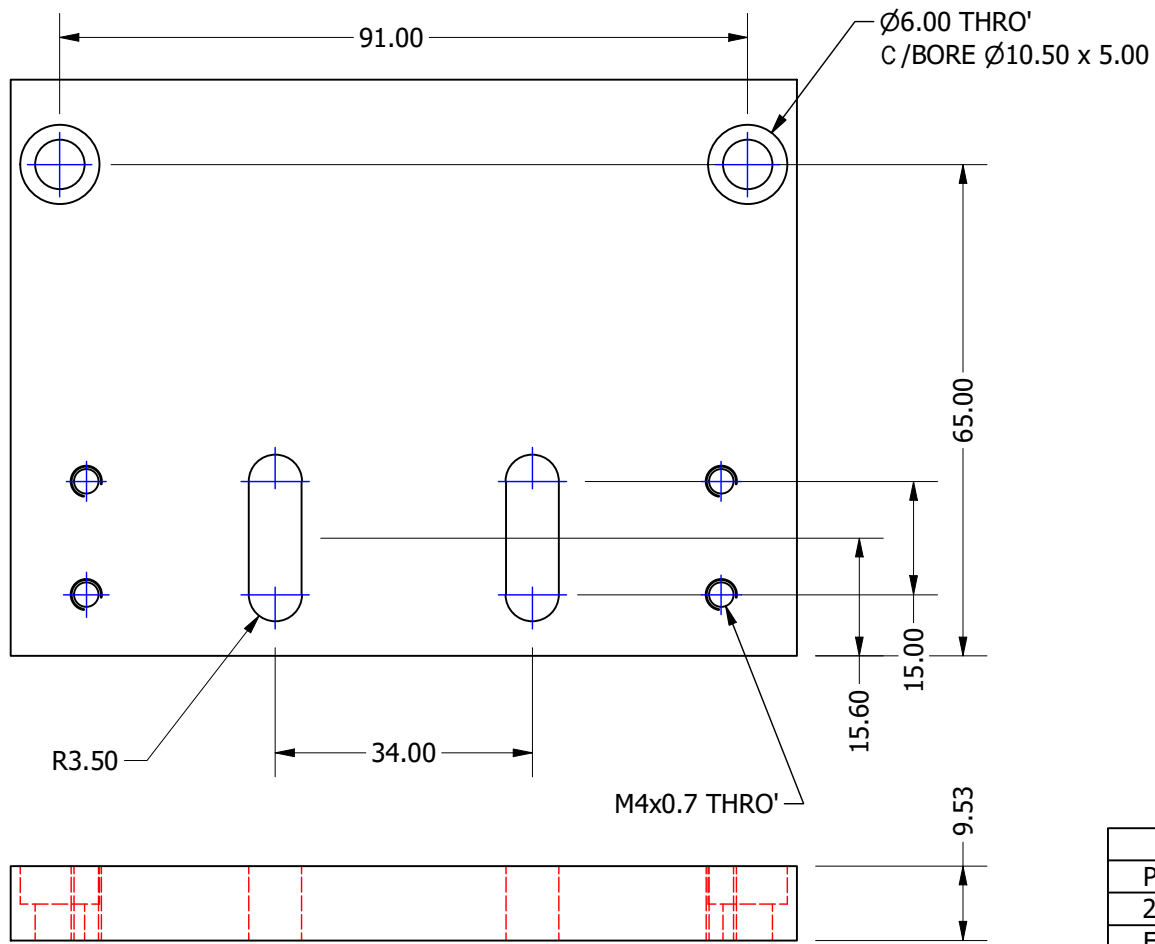

(QTY 1) ED-2768/1 TAPPED ANGLE

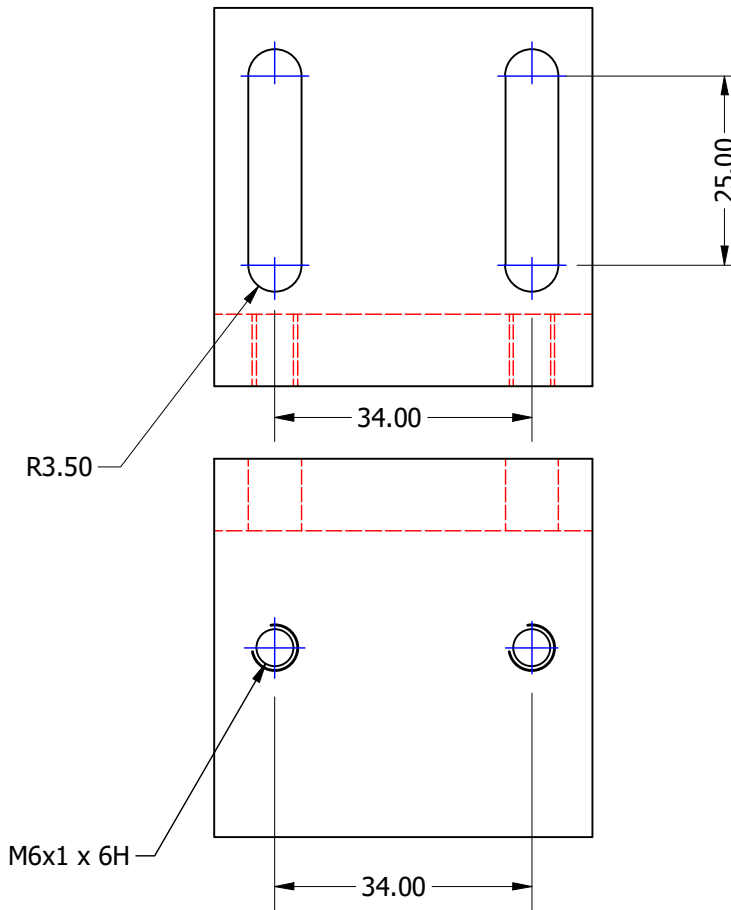

(QTY 1) ED-2768/10 HEAVY DUTY TAPPED ANGLE

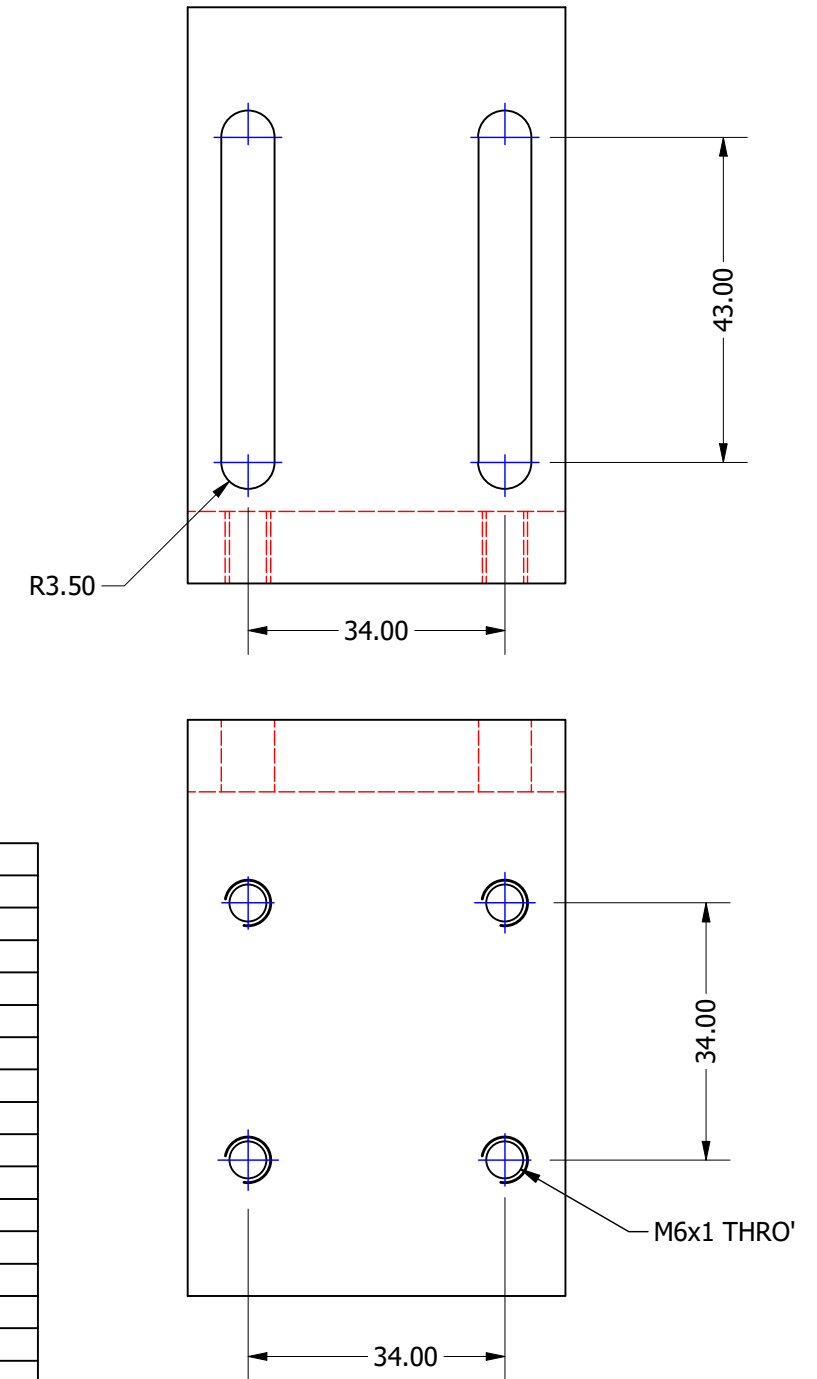

(QTY 1) 295-00975 CROSS BRACKET

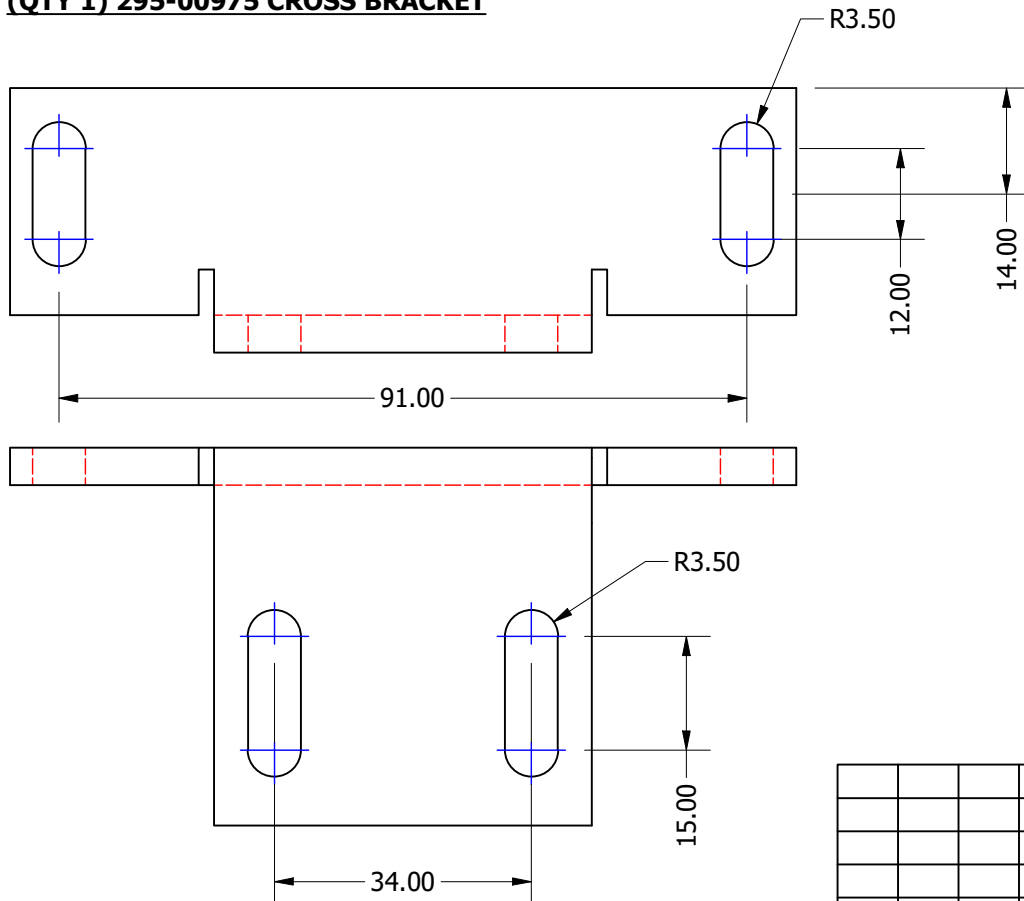

BOM		
Pt Number	Description	Qty
295-00990	S300 PLATE BRACKET A 295-00990/0	2
ED-2768-1	TAPPED ANGLE DRWG TO REV.L ECN9077	1
ED-2768-10	HEAVY DUTY TAPPED ANGLE DRWG TO REV.L ECN9077	1
295-00975	S300 CROSS AXIS BRACKET A 295-00975/0	1
	M5 FLAT WAHSHER	2
	M5 x 10 SOCKET HEAD SCREW	4
	M6 FLAT WASHER	8
	M6 x 20 SOCKET HEAD SCREW	8
	M4 x 12 SOCKET GRUB SCREWS	4
	P CLIP NYLON N4-B	4
	P CLIP METAL AL-4	4
	M4 x 12 TAPTITE SCREWS	8
	CABLE TIES	10
023-82392	BRACKETS DATA SHEET LBK010 023-82392/0	1
SSE010	SPHEROSYN SINGLE END MOUNT KIT	1

ALSO INCLUDED, SPHEROSYN SINGLE END SCALE MOUNTING KIT (SSE010)

BOM		
Pt Number	Description	Qty
294-23090	SINGLE END MTG. BLOCK UK TYPE	1
	M6 x 20 SOCKET HEAD SCREW	1
	M5 x 10 SOCKET HEAD SCREW	1
	M5 x 16 GRUB SCREW	4
	M5 FLAT WASHER	1
	M6 FLAT WASHER	1
023-82375	BRACKETS DATA SHEET SSE010 023-82375/0	1

REV. ISS.	DATE	C.N.No	ALTERATION	TITLE	MATERIAL/FINISH	SCALE	UNLESS OTHERWISE STATED: -	TOLERANCES: - 0 DECIMAL PLACES ± 0.5 1 DECIMAL PLACES ± 0.2 2 DECIMAL PLACES ± 0.1 ANGULAR ± 1'
				LBK010 - BRACKET KIT	SEE ABOVE	N.T.S		
				DRAWN Chris.Wh		SHEET 3 OF 3	DIMENSIONS ARE IN M.M	
				DATE 21/12/2017	Leicester		DRAWING NUMBER 023-82392	REV. ISS. 0

NEWALL England

THIS DRAWING IS THE PROPERTY OF NEWALL MEASUREMENT SYSTEMS LTD. THE INFORMATION THEREON MAY NOT BE COPIED OR USED WITHOUT WRITTEN PERMISSION