

PART NO: (UBK010)
 2 AXIS UNIVERSAL ENCODER MOUNTING KIT
 FITS 2 SPHEROSYN "300" OR "SERIAL" ENCODERS
 USE IN CONJUNCTION WITH ENCODER INSTALL GUIDE 023-82510

MISC FITTING OPTIONS - SOME MODIFICATION OF BRACKETS MAY BE REQUIRED

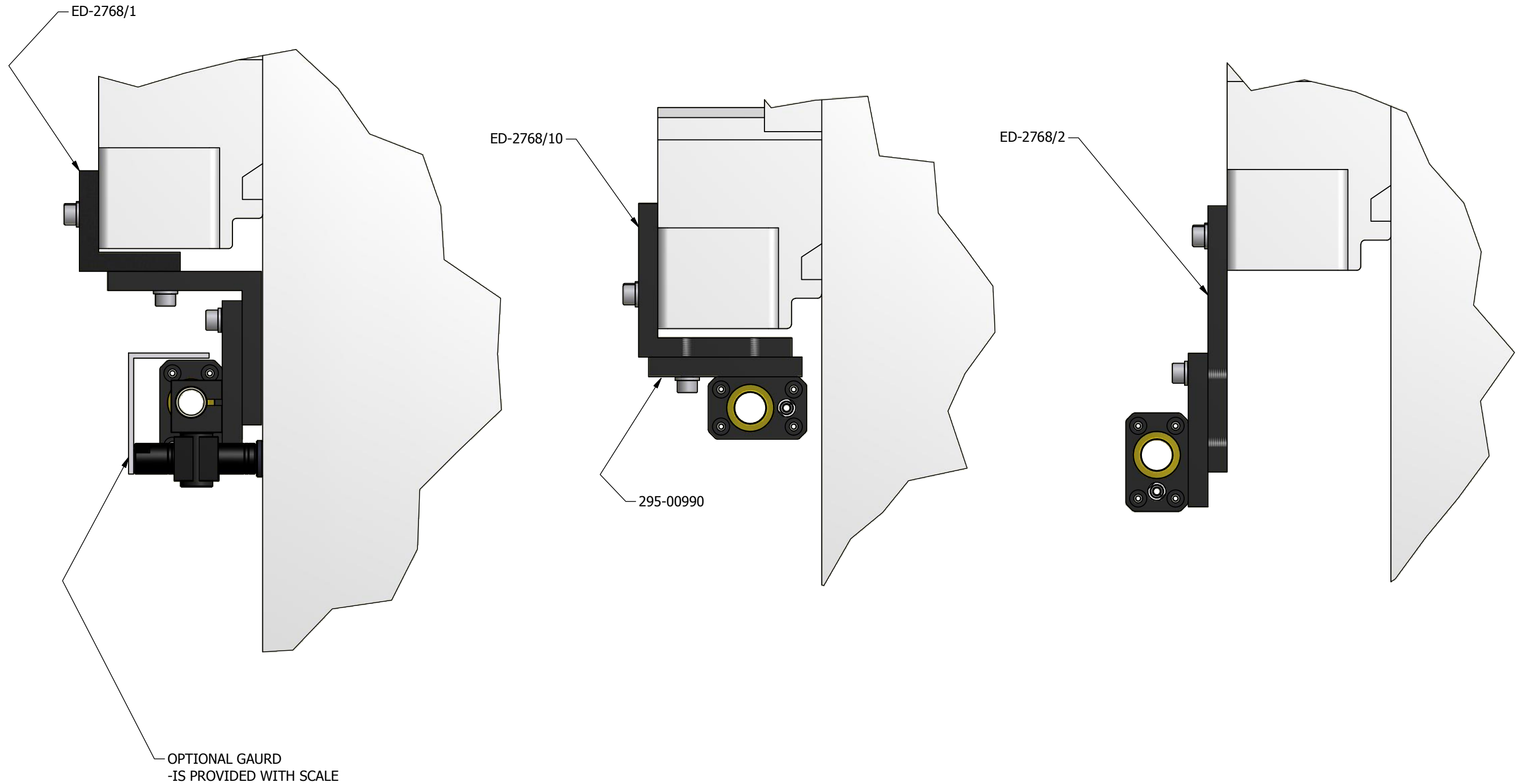

OPTIONAL GAURD
 -IS PROVIDED WITH SCALE

				TITLE UBK010 - BRACKET KIT		MATERIAL/FINISH See Above		SCALE N.T.S		UNLESS OTHERWISE STATED: - TOLERANCES: - 0 DECIMAL PLACES ± 0.5 1 DECIMAL PLACES ± 0.2 2 DECIMAL PLACES ± 0.1 ANGULAR ± 1'	
				DRAWN Chris.Wh		NEWALL England		SHEET 1 OF 2		DIMENSIONS ARE IN M.M	
REV. ISS.	DATE	C.N.No	ALTERATION	DATE	15/03/2018			DRAWING NUMBER 023-82400		REV. ISS. 0	

THIS DRAWING IS THE PROPERTY OF NEWALL MEASUREMENT SYSTEMS LTD. THE INFORMATION THEREON MAY NOT BE COPIED OR USED WITHOUT WRITTEN PERMISSION

KIT CONTENTS FOR: UBK010

(QTY 2) 295-00990 PLATE BRACKET

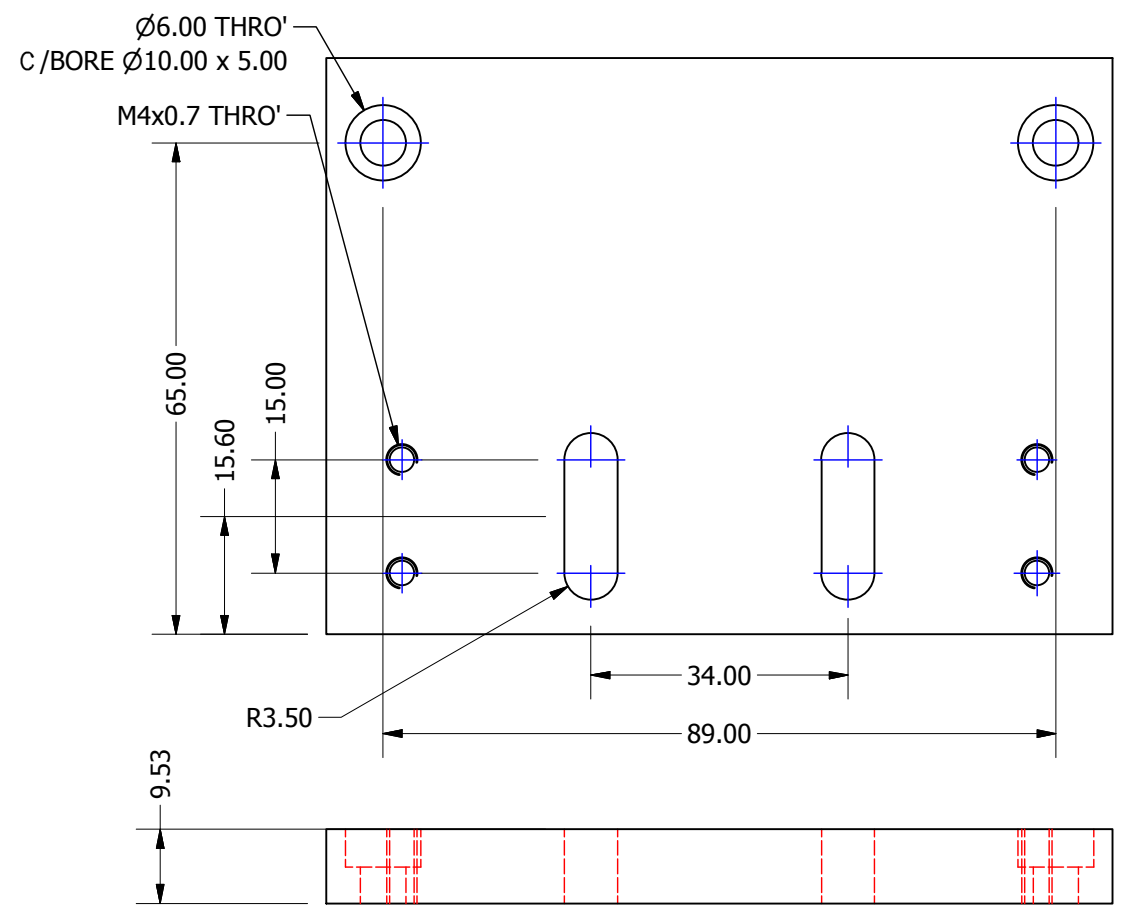

(QTY 1) ED-2768/1 ANGLE BRACKET

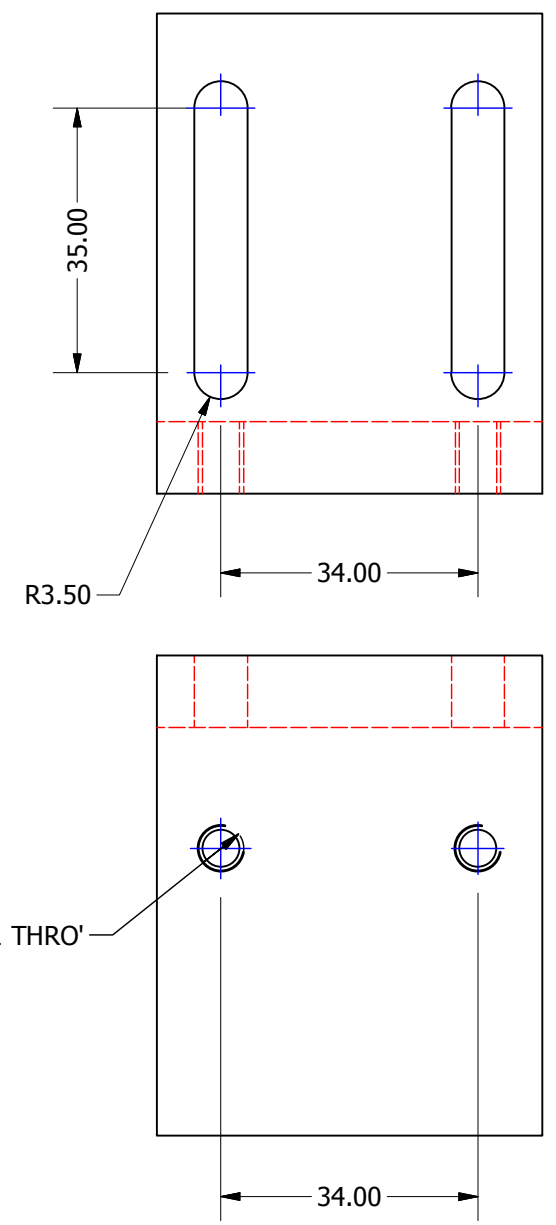

(QTY 1) ED-2768/2 SUPPORT PLATE

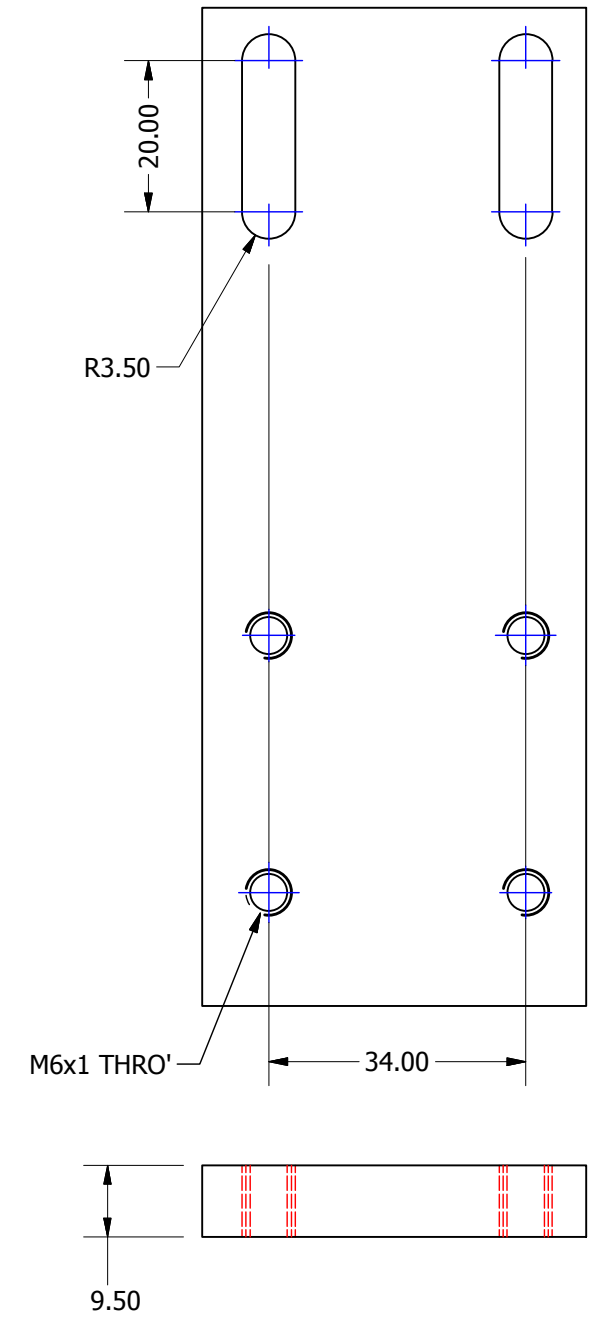

(QTY 1) ED-2768/10 HEAVY DUTY ANGLE

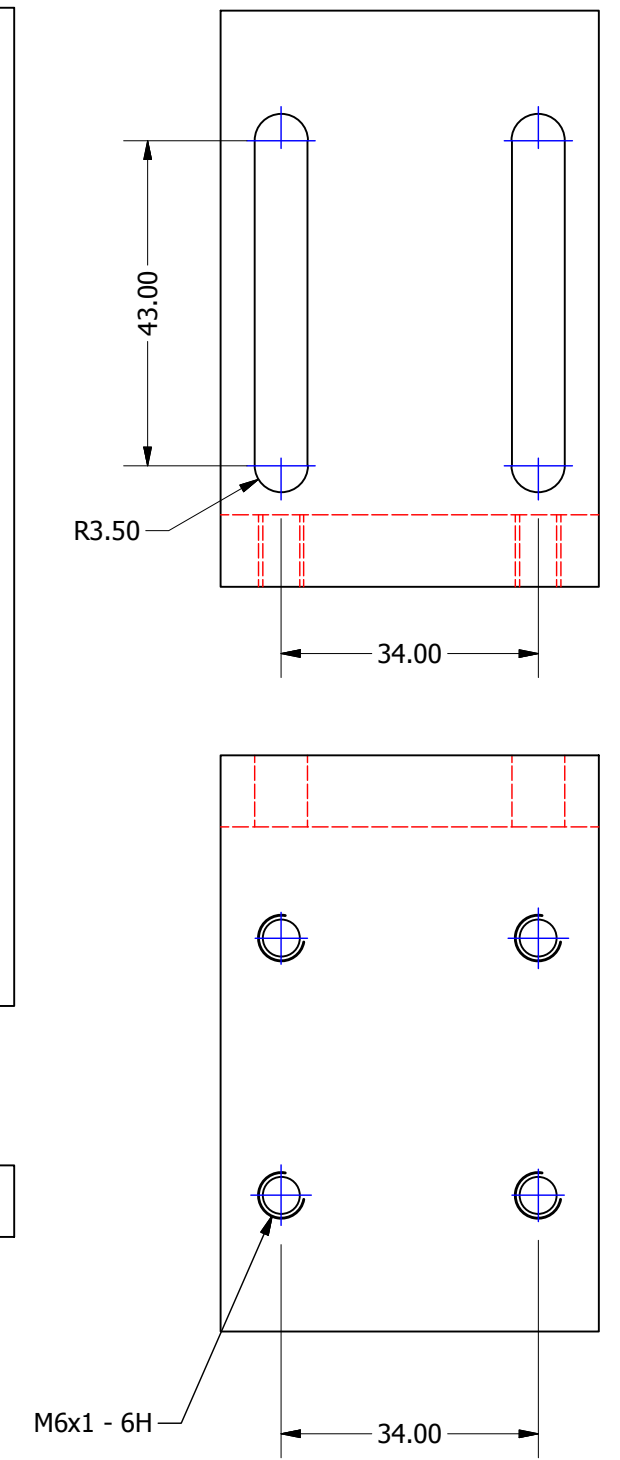

BOM		
Pt Number	Description	Qty
ED-2768/10	HEAVY DUTY TAPPED ANGLE DRWG TO REV.L ECN9077	1
ED-2768/2	SUPPORT PLATE 1/C/2 DRWG TO REV.O ECN9077	1
ED-2768/1	BRACKET 294-98300/0	1
295-00990	S300 PLATE BRACKET A 295-00990/0	2
	M6 x 20 SOCKET CAP HD SCREW	12
	M6 FLAT WASHER	12
	M5 x 10 SOCKET CAP HD SCREW	4
	M4 x 12 GRUB SCREWS	8
	CABLE TIES	10
	P CLIP NYLON N4-B	8
	P CLIP METAL AL-4	8
	M4 x 12 TAPTITE SCREWS	16
023-82400	BRACKETS DATA SHEET LBK040 023-82400/0	1

				TITLE UBK010 - BRACKET KIT		MATERIAL/FINISH SEE ABOVE		SCALE N.T.S		UNLESS OTHERWISE STATED: - TOLERANCES: - 0 DECIMAL PLACES ± 0.5 1 DECIMAL PLACES ± 0.2 2 DECIMAL PLACES ± 0.1 ANGULAR ± 1'	
				DRAWN Chris.Wh		NEWALL Leicester England		SHEET 2 OF 2		DIMENSIONS ARE IN M.M DRAWING NUMBER 023-82400	
REV. ISS.	DATE	C.N.No	ALTERATION	DATE	15/03/2018					REV. ISS.	0