

| 718 SERIES

CLAMSHELL FOR CSP/BGA PACKAGES

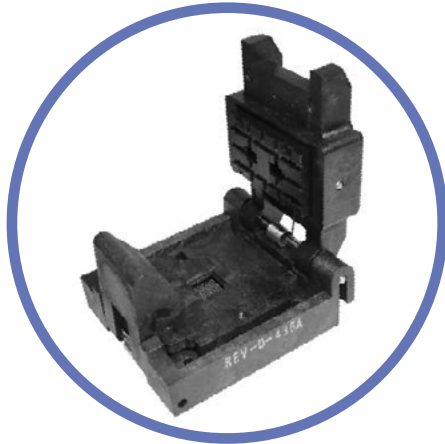

Features

- Clamshell design, compression surface mount
- Spring and probe contact
- Pointed probe maintains continuous contact to PCB
- Spring loaded pressure pad and locator plate
- Multi-site options are available
- Any pitch or pitch combination .4mm and greater
- Threaded inserts available
- Available with high performance pin



SPECIFICATIONS

Materials and Specifications

| | |
|---------------------------|---|
| Body Materials | PEI, PES, or Equivalent |
| Contact Material | Beryllium Copper Alloy |
| Contact Plating | Gold over Nickel |
| Contact Force | 12-15 grams average |
| Contact Resistance | 350 mΩ typical |
| Temperature Rating | Burn-in 125°C Higher Temperatures, consult factory |
| Durability | 10,000 cycles min. |

| Pitch e (mm) | Maximum Lead Count | Minimum Body Size | Maximum Body Size | Maximum Matrix |
|--------------|--------------------|-------------------|-------------------|----------------|
| 0.50 | 484 | 1 x 1* | 16 x 14 | 22 x 22 |
| 0.65 | 441 | 1 x 1* | 16 x 14 | 21 x 21 |
| 1.00 | 121 | 1 x 1* | 16 x 14 | 11 x 11 |

* For package size less than 1 x 1, consult factory
For all other pitches, see next page

| Pitch e (mm) | Package Size (mm) | Matrix | Part Number |
|--------------|-------------------|--------|----------------------|
| 0.50 | 0.9X0.9 | 2X2 | 718-00401L504-XX |
| | 1.40X0.90 | 3X2 | 718-00601W504-XX |
| | 1.57X1.09 | 3X2 | 718-00601V504-XX |
| | 1.90X0.90 | 4X2 | 718-00801F504-XX |
| | 1.90X1.40 | 4X3 | 718-01201Y504-XX |
| | 2X2 | 4X4 | 718-01602-5XX-XX |
| | 2X2.5 | 4X3 | 718-01202L504-XX |
| | 2.5X2.5 | 4X4 | 718-01502A-5XX-XX |
| | 2.51X1.51 | 5X3 | 718-01502F504-XX-01 |
| | 2.64X2.56 | 5X5 | 718-02502A502-XX |
| | 2.98X2.47 | 6X5 | 718-03002M504-XX |
| | 3X2.5 | 5X4 | 718-02003F504-XX |
| | 3.36X3.36 | 6X6 | 718-03203B5XX-XX-01* |
| | 3.5X3.5 | 6X6 | 718-03603C504-XX |
| | 3.57X3.57 | 6X6 | 718-03303HS04-XX-01 |
| | 3.97X3.97 | 8X8 | 718-06403E504-XX-01 |
| | 4X4 | 4X4 | 718-01604-9XX-XX |
| | 4X4 | 7X7 | 718-048004-5XX-XX |
| | 4X4 | 7X7 | 718-04904-5XX-XX |
| | 4.27X4.27 | 7X7 | 718-04804C5XX-XX |
| | 4.35X4.2 | 7X7 | 718-04704A5XX-XX |
| | 4.42X4.42 | 8X8 | 718-06304D5XX-XX-01 |
| | 4.5X4.5 | 8X8 | 718-06004HS04-XX |
| | 4.76X3.41 | 8X5 | 718-04004F504-XX-02 |
| | 4.88X3.53 | 8X5 | 718-04004J504-XX-S1 |
| | 5X5 | 9X9 | 718-04805-504-XX |
| | 5X5 | 9X9 | 718-05705-504-XX |
| | 5X5 | 9X9 | 718-05705-504-XX-01 |
| | 5X5 | 9X9 | 718-05705-504-XX-02 |
| | 5X5 | 8X8 | 718-06405-5XX-XX |
| | 5X5 | 9X9 | 718-08005-5XX-XX |
| | 5X5 | 9X9 | 718-08005-504-XX |
| | 5X5 | 9X9 | 718-08105-5XX-XX |
| | 5.07X3.06 | 9X5 | 718-04205CXX-XX-01 |
| | 5.5X5.5 | 10X10 | 718-08705E504-XX |
| | 5.81X5.56 | 10X10 | 718-09305K504-XX |
| | 5.8X5.4 | 11X10 | 718-08806L504-XX-01 |

| Pitch e (mm) | Package Size (mm) | Matrix | Part Number |
|--------------|-------------------|------------------|---------------------|
| 0.50 | 5.9X5.1 | 10X8 | 718-07205J504-XX |
| | 6X3.5 | 10X6 | 718-05606K50X-XX |
| | 6X5 | 11X6 | 718-04806G504-XX |
| | 6X5 | 11X6 | 718-04806G504-XX |
| | 6X6 | 9X9 | 718-04906-5XX-XX |
| | 6X6 | 10X10 | 718-05606-5XX-XX |
| | 6X6 | 10X10 | 718-06406-5XX-XX |
| | 6X6 | 8X8 | 718-06406-5XX-XX |
| | 6X6 | 10X10 | 718-06806-504-XX-01 |
| | 6X6 | 10X10 | 718-08006-5XX-XX-01 |
| | 6X6 | 10X10 | 718-08406-5XX-XX |
| | 6X6 | 10X10 | 718-08406-504XX-01 |
| | 6X6 | 10X10 | 718-08406-50X-XX |
| | 6X6 | 11X11 | 718-08806-5XXXX |
| | 6X6 | 10X10 | 718-08806-504-XX-01 |
| | 6X6 | 11X11 | 718-09606-5MM |
| | 6X6 | 11X11 | 718-10406-5J00(X-01 |
| | 6X6 | 11X11 | 718-10506-5XX-XX |
| | 6X6 | 11X11 | 718-11106-5XX-XX |
| | 6X8 | 14X8 | 718-04408A504-XX |
| | 6.29X10.53 | 4X10 | 718-04010A-502-XX |
| | 7X7 | 11X11 | 718-07207-502XX |
| | 7X7 | 11X11 | 718-07207-504XX |
| | 7X7 | 12X12 | 718-08407-502XX |
| | 7X7 | 13X13 | 718-08807-5XX-XX |
| | 7X7 | 12X12 | 718-10007-5XX-XX-01 |
| | 7X7 | 12X12 | 718-10007-504-XX-01 |
| | 7X7 | 12X12 | 718-10807-5XXXX |
| | 7X7 | 12X12 | 718-10807-504-XX-01 |
| | 7X7 | 12X12 | 718-10807-504XX-01 |
| | 7X7 | 12X12 | 718-11207-504-XX-01 |
| | 7X7 | 12X12 | 718-12007-504-XX-01 |
| | 7X7 | 11X11 | 718-12107-504XX |
| | 7X7 | 12X12 | 718-14307-502-XX |
| | 7X7 | 12X12 | 718-14407-504XX |
| | 7X7 | 13X13 | 718-14407-504-XX |
| 7X7 | 12X12 | 718-14407-504XX | |
| 7.06X3.25 | 8X6 | 718-04807B5XX-XX | |

| Pitch e (mm) | Package Size (mm) | Matrix | Part Number |
|--------------|-------------------|--------|----------------------|
| 0.50 | 8X8 | 14X14 | 718-10008-504XX |
| | 8X8 | 14X14 | 718-10808-5XX-XX |
| | 8X8 | 14X14 | 718-10808-5XX-XX |
| | 8X8 | 14X14 | 718-11608-5XX-XX |
| | 8X8 | 13X13 | 718-12808-502-XX |
| | 8X8 | 14X14 | 718-13208-504XX-01 |
| | 8X8 | 14X14 | 718-14408-502-XX |
| | 8X8 | 14X14 | 718-14408-5XXX-01 |
| | 8X8 | 14X14 | 718-14408-504-XX-01 |
| | 8X8 | 14X14 | 718-15208-504XX |
| | 8X8 | 14X14 | 718-15908-5XX-XX |
| | 8X8 | 15X15 | 718-16108-504-XX |
| | 8X8 | 14X14 | 718-16408-504-XX-01 |
| | 8X8 | 13X13 | 718-16908-504XX |
| | 8X8 | 15X15 | 718-17608-5XX-XX |
| | 8X8 | 14X14 | 718-19608-502-XX |
| | 8X8 | 14X14 | 718-19608-504XX-01 |
| | 8X8 | 15X15 | 718-22508-5XX-XX-01 |
| | 8.5X8 | 16X15 | 718-24008E504-XX |
| | 8.5X8.5 | 16X16 | 718-19208D5044-XX |
| | 8.5X8.5 | 16X16 | 718-25608D504-XX-01 |
| | 9X9 | 16X16 | 718-17608-5044-XX-01 |
| | 9X9 | 16X16 | 718-17609-504-XX-02 |
| | 9X9 | 17X17 | 718-18809-5XX-XX |
| | 9X9 | 16X16 | 718-18809-5XX-XX |
| | 9X9 | 16X16 | 718-18809-504-XX-01 |
| | 9X9 | 16X16 | 718-19209-504-XX |
| | 9X9 | 16X16 | 718-25609-5044-XX-01 |
| | 9X9 | 17X17 | 718-28809-504-XX |
| | 10.53X6.29 | 10X4 | 718-04010A5XX-XX-01 |
| | 10.9X10.1 | 19X19 | 718-28111A5XX-XX-01 |
| | 10X10 | 17X17 | 718-18110-5XX-XX |
| | 10X10 | 18X18 | 718-18410-5XX-XX |
| | 10X10 | 18X18 | 718-20810-5044-XX-01 |
| | 10X10 | 18X18 | 718-24010-504-XX-01 |
| | 10X10 | 18X18 | 718-24510-5044-XX-01 |
| | 10X8 | 14X10 | 718-05610D5044-XX |
| | 11X11 | 17X17 | 718-24011-5XX-XX-01 |

| Pitch e (mm) | Package Size (mm) | Matrix | Part Number |
|--------------|-------------------|------------|----------------------|
| 0.50 | 11X11 | 20X20 | 718-25611-5XX-XX |
| | 12.5X7 | 24X13 | 718-22812A5XX-XX-01 |
| | 12X12 | 22X22 | 718-22812-5XX-XX |
| | 12X12 | 21X21 | 718-24412-XXX-XX |
| | 12X12 | 22X22 | 718-27212-5044-XX-01 |
| | 12X12 | 22X22 | 718-27612-500-XX |
| | 12X12 | 19X19 | 718-28812-5XX-XX-01 |
| | 12X12 | 22X22 | 718-29112-5044-XX-01 |
| | 12X12 | 22X22 | 718-32412-5044-XX |
| | 12X12 | 22X22 | 718-34412-504-XX-01 |
| | 13X13 | 22X22 | 718-30013-502-XX |
| | 13X13 | 23X23 | 718-31613-5044-XX-01 |
| 0.65 | 12X12 | 17X17 | 718-20812-604-XX-01 |
| | 12X12 | 17X17 | 718-28912-604-XX-01 |
| | 12X12 | 18X18 | 718-30012-6044-XX-01 |
| | 13X13 | 18X18 | 718-24813-604-XX-01 |
| | 13X13 | 19X19 | 718-28013-6XX-XX |
| | 13X13 | 19X19 | 718-28013-6044-XX-02 |
| | 14X12 | 20X17 | 718-19014C604-XX |
| | 10X4.5 | 14X6 | 718-08310A6XX-XX |
| | 5X5 | 7X7 | 718-04905-6XX-XX |
| | 5X5 | 7X7 | 718-04905-6XX-XX |
| | 6X6 | 8X8 | 718-06406-6044-XX-01 |
| | 8X8 | 11X11 | 718-09608-604-XX |
| | 8X8 | 11X11 | 718-09608-604-XX-01 |
| | 8X8 | 11X11 | 718-12108-6XX-XX |
| | 1.00 | 11.63X8.38 | 11X8 |
| 12X10 | | 10X8 | 718-08012D9044-XX |
| 7X4.5 | | 5X3 | 718-01407A9044-XX |
| 8.46X6.27 | | 7X5 | 718-02108A9XX-XX |



DIMENSIONS AND DIAGRAMS

Dimensions in mm (inches)

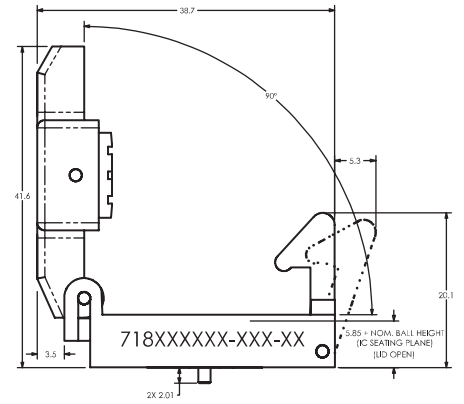
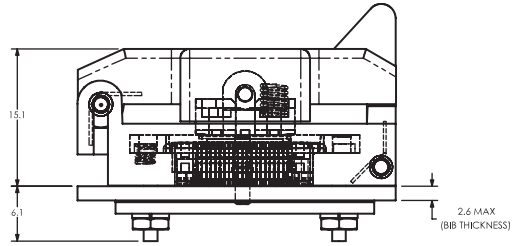
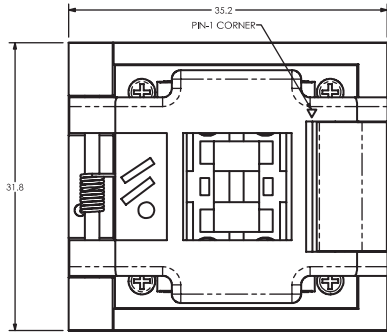

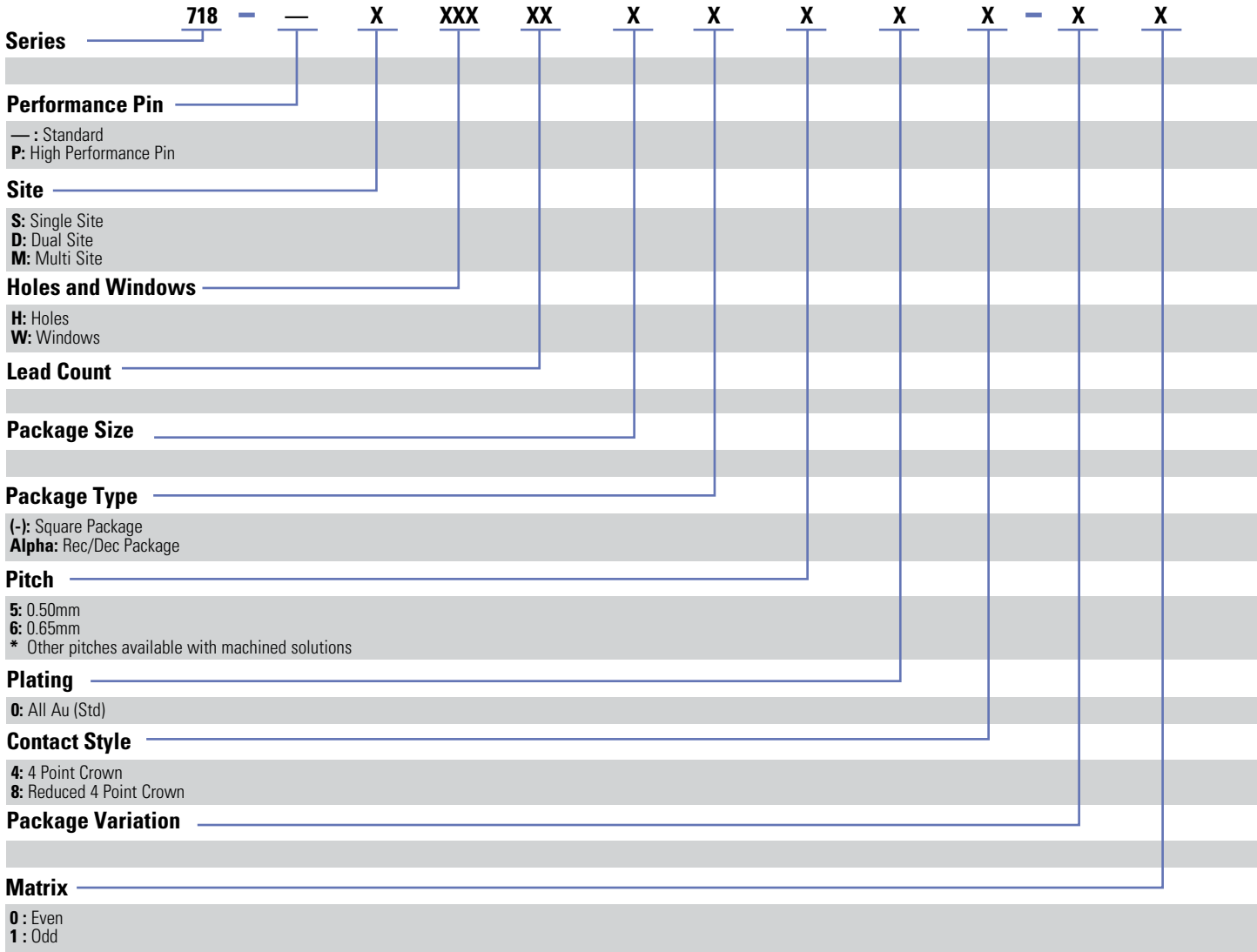

Revised 02/06/18

Sensata Technologies, Inc. ("Sensata") data sheets are solely intended to assist designers ("Buyers") who are developing systems that incorporate Sensata products (also referred to herein as "components"). Buyer understands and agrees that Buyer remains responsible for using its independent analysis, evaluation and judgment in designing Buyer's systems and products.

Buyers are authorized to use Sensata data sheets with the Sensata component(s) identified in each particular data sheet. HOWEVER, NO OTHER LICENSE, EXPRESS OR IMPLIED, BY ESTOPPEL OR OTHERWISE TO ANY OTHER SENSATA INTELLECTUAL PROPERTY RIGHT, AND NO LICENSE TO ANY THIRD PARTY TECHNOLOGY OR INTELLECTUAL PROPERTY RIGHT, IS GRANTED HEREIN.

All products are sold subject to Sensata's terms and conditions of sale supplied at www.sensata.com SENSATA ASSUMES NO LIABILITY FOR APPLICATIONS ASSISTANCE OR THE DESIGN OF BUYERS' PRODUCTS. BUYER ACKNOWLEDGES AND AGREES THAT IT IS SOLELY RESPONSIBLE FOR COMPLIANCE WITH ALL LEGAL, REGULATORY AND SAFETY-RELATED REQUIREMENTS CONCERNING ITS PRODUCTS.

Mailing Address: Sensata Technologies, Inc., 529 Pleasant Street, Attleboro, MA 02703, USA.

CONTACT US

Americas
480.682.6148 or 480.681.6116